

FOR LEASE

Owned and Operated by



33rd Street Industrial Center Bldg 8

4210 LB McLeod Road, Orlando, FL 32811

3,640 SF



**LEASING INFO
& CONTACT**

Derek Riggleman SIOR

321.281.8507 / driggleman@lee-associates.com

**LEE &
ASSOCIATES**
COMMERCIAL REAL ESTATE SERVICES

This is not an offer or acceptance of an offer to lease space. A lease will only be offered or made in a written agreement signed by landlord. No representation or warranty of any kind is made by landlord unless set forth in a written definitive lease executed by the landlord.

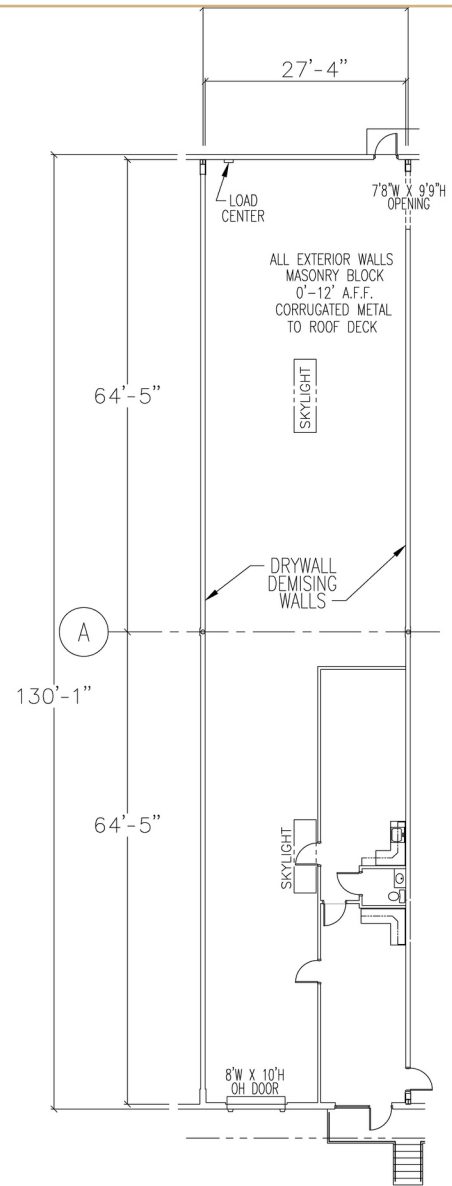

BUILDING DATA

Building Size:	65,000 SF
Ceiling Height:	22'
Column Spacing:	28' W x 65' D
Truck Court:	100'
Building Depth:	130'

LISTING DATA

Available Size:	Suite 115 - 3,640 SF
Office Size:	743 SF
Lease Rate:	\$15.95/SF NNN
Op Ex:	\$2.97/SF

