

**NOTE:**  
 THE ELEVATOR SHALL BE OTIS, OR EQUIVALENT (2,500# CAPACITY) WITH 5' 0" CLEARANCE TO THE CEILING. THE ELEVATOR SHALL BE 5' 0" WIDE BY 4' 6" DEEP WITH AN EQUAL MAINTENANCE SPACE ON BOTH SIDES. THE GENERAL CONTRACTOR SHALL SUBMIT SHOP DRAWINGS FOR APPROVAL PRIOR TO INSTALLATION. SEE SPECS.

**FLOOR PLAN**  
 SCALE 1/8" = 1'-0"

- NOTES:**
- 1 - FOR WATER COOLER DESCRIPTION SEE EQUIPMENT AND ACCESSORIES SCHEDULE ON DRAWING NO. A-19
  - 2 - WATER COOLER NO. 24
  - 3 - FINISH FLOOR ELEVATIONS (THREE LEVELS)
  - 4 - MANUFACTURING AREA (134.50 MTS)
  - 5 - ELECTRICAL PLATFORMS (27.93 MTS)
  - 6 - MEZZANINE (31.36 MTS)

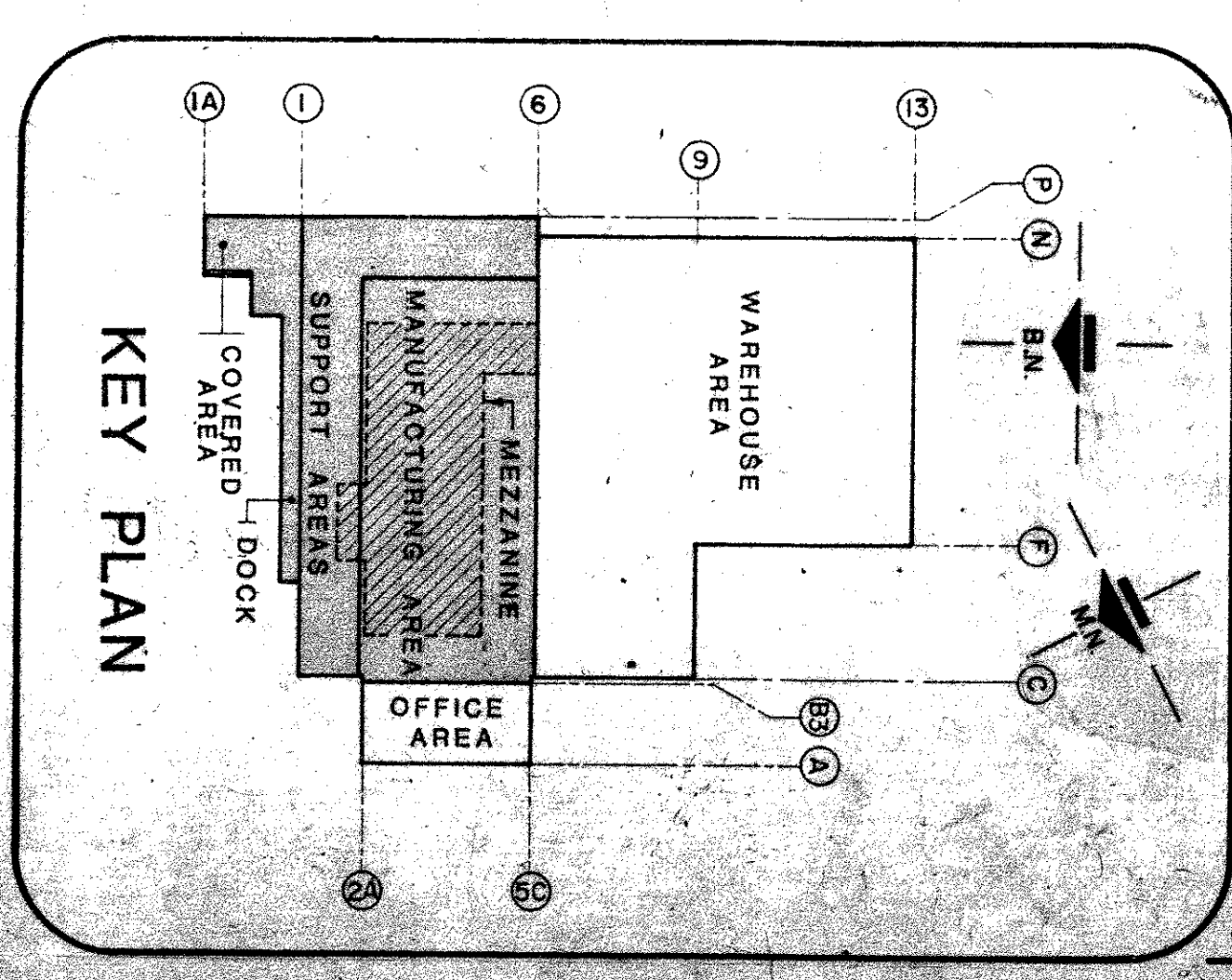

**LEBRON SANFLORENZO & FUENTES**  
 ENGINEERING, ARCHITECTURAL AND PLANNING CONSULTANTS  
 P.O. BOX 14, CARMONA HEIGHTS STATION, SAN JUAN, PUERTO RICO 00923  
 MAIN AND DUNA STREETS, LAMBOU DR., AND PASADENA, PUERTO RICO  
 TEL. (809) 743-3464

PROJECT NO.	79-576-300
DATE	A-2
NO. OF SHEETS	90
SHEET NO.	152

**REYNOLDS METALS CO.**  
 OFFICE, SUPPORT AND MANUFACTURING AREAS GENERAL AND FLOOR PLAN  
 DATE: 5-23-80, DWT: 6-23-80, E 26-00-8024