

# EXECUTIVE SUMMARY

Corporate Park at Palm Bay • 1571-1591 Robert J Conlan Blvd Palm Bay, FL 32905



## OFFERING SUMMARY

**Available SF:** 1,885 - 25,441 SF

**Lease Rate:** \$10.00 - 12.00 SF/yr  
(\$2.57 NNN)

**Lot Size:** 6.98 Acres

**Year Built:** 1988

**Building Size:** 71,968 SF

**Zoning:** LI

## PROPERTY OVERVIEW

This is a three (3) building Corporate Park well located in Palm Bay's Business Hub. This project has two (2) Office Spaces available. The Office Space is a Direct Lease.

If you are looking for nice office space with about 10,000 sf of warehouse space, be sure to check out Corporate Park at Palm Bay.

Near L3Harris, DRS, and other Industrial & High Tech Companies

Well managed facility with ample parking and easy access to Palm Bay Road, and Highway 1

Buildings have a mix of office, warehouse, and flex space.

## LOCATION OVERVIEW

Located on Robert J Conlan Blvd near Palm Bay Rd

Tranquil Office Park setting

Great Central Brevard Location

Easy access to Hwy A1A and Palm Bay Road

### ROB BECKNER, SIOR

Principal  
321.722.0707 X11  
rob@teamlbr.com

### MIKE MOSS, SIOR

Principal | Industrial Team Director  
321.543.2498  
mike@teamlbr.com

### CHARLES DUVALL

Office Sales & Leasing  
321.722.0707 X19  
charles@teamlbr.com

### Lightle Beckner Robison, Inc.

321.722.0707 • teamlbr.com  
70 W. Hibiscus Blvd.,  
Melbourne, FL 32901

Information contained herein has been obtained through sources deemed reliable but cannot be guaranteed as to its accuracy. A purchaser or lessee is expected to verify all information to his/her own satisfaction. Zoning information subject to change and not warranted. Always confirm current requirements with local governing agencies.

# FLOOR PLANS - WAREHOUSE

Corporate Park at Palm Bay • 1571-1591 Robert J Conlan Blvd Palm Bay, FL 32905

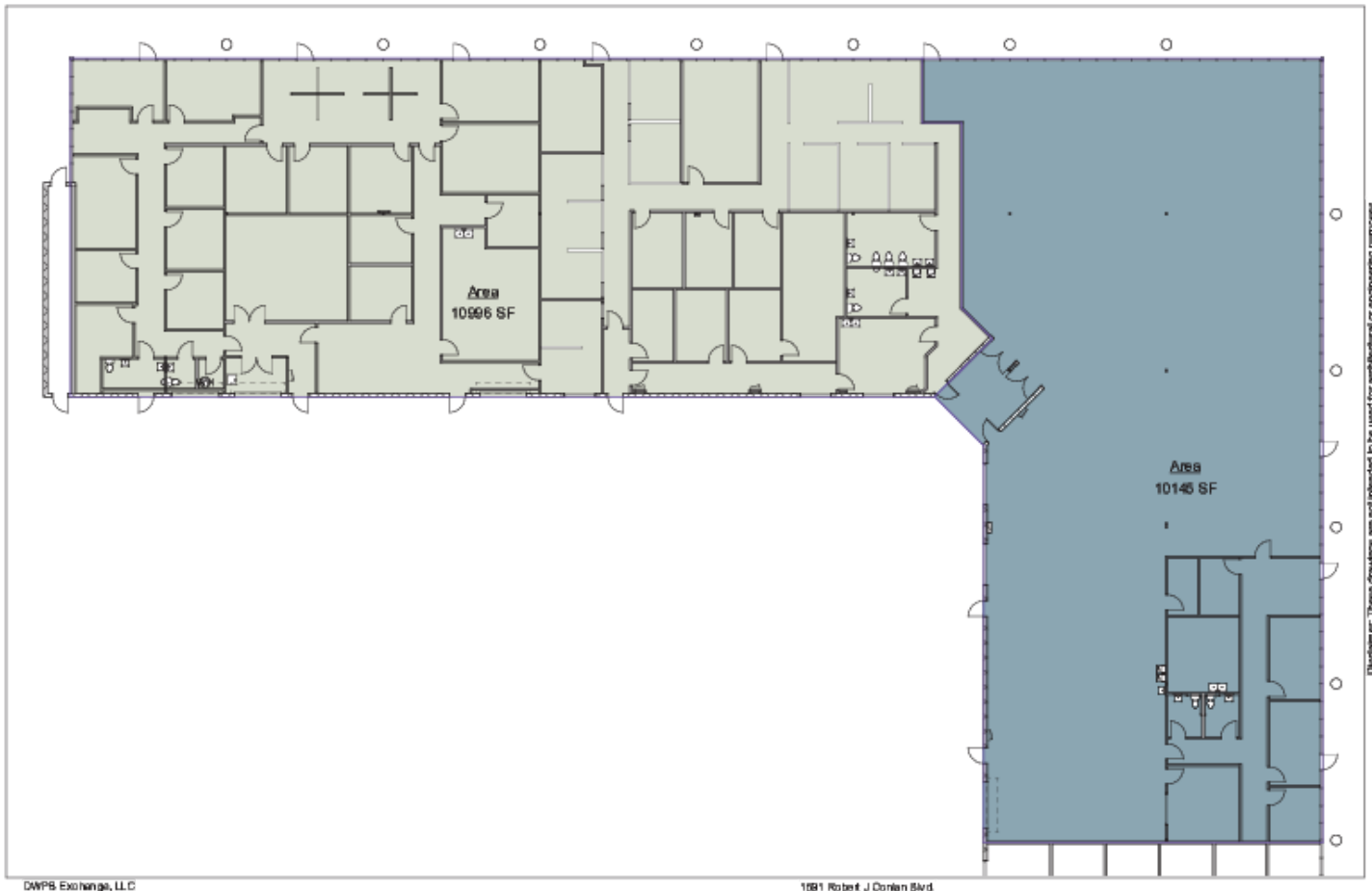

DWPB Exchange, LLC

1091 Robert J Conlan Blvd

## ROB BECKNER, SIOR

Principal  
321.722.0707 X11  
rob@teamlbr.com

## MIKE MOSS, SIOR

Principal | Industrial Team Director  
321.543.2498  
mike@teamlbr.com

## CHARLES DUVALL

Office Sales & Leasing  
321.722.0707 X19  
charles@teamlbr.com

## Lightle Beckner Robison, Inc.

321.722.0707 • teamlbr.com  
70 W. Hibiscus Blvd.,  
Melbourne, FL 32901

Information contained herein has been obtained through sources deemed reliable but cannot be guaranteed as to its accuracy. A purchaser or lessee is expected to verify all information to his/her own satisfaction. Zoning information subject to change and not warranted. Always confirm current requirements with local governing agencies.

# FLOOR PLANS

Corporate Park at Palm Bay • 1571-1591 Robert J Conlan Blvd Palm Bay, FL 32905

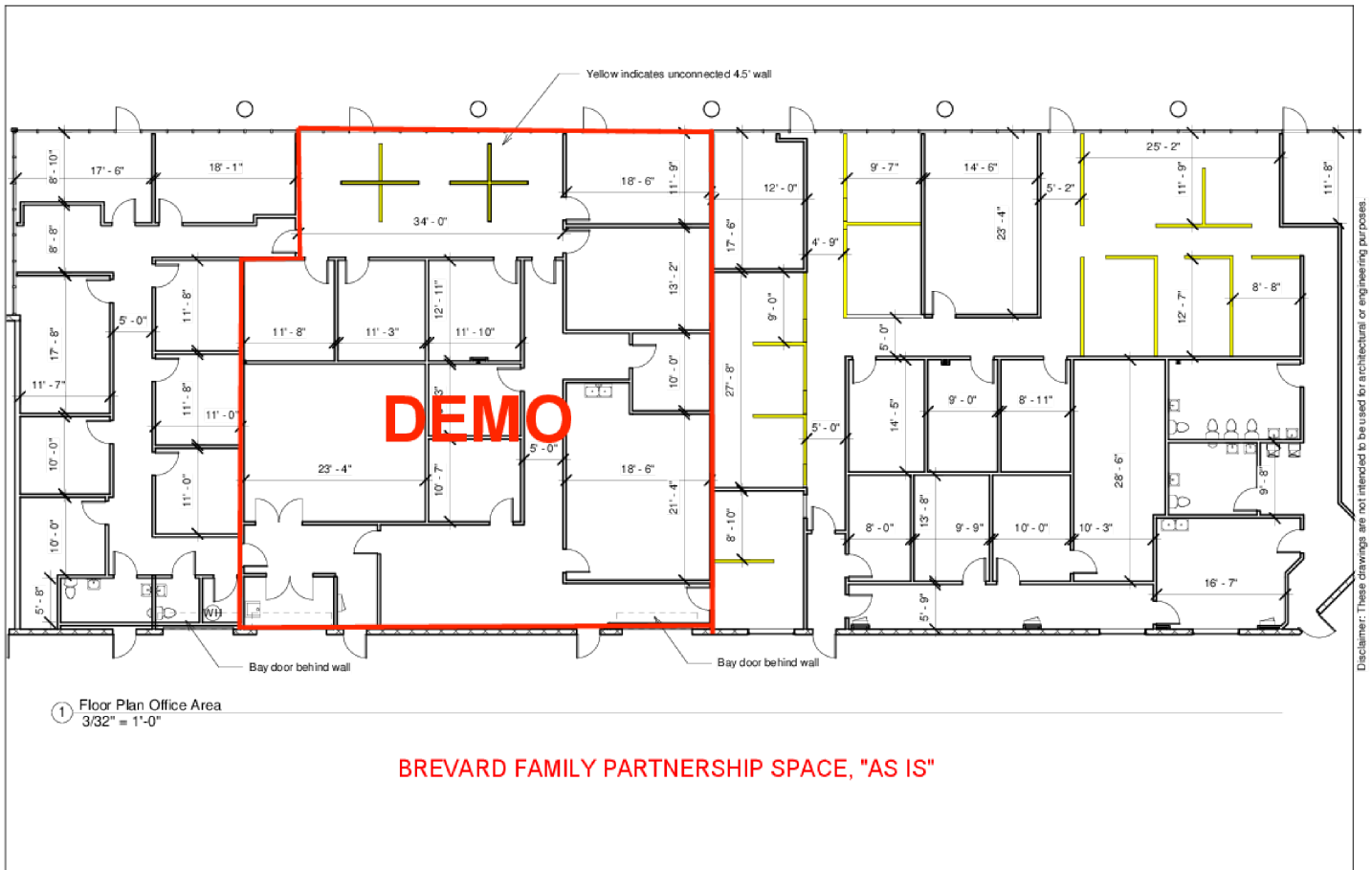

## ROB BECKNER, SIOR

Principal  
321.722.0707 X11  
rob@teamlbr.com

## MIKE MOSS, SIOR

Principal | Industrial Team Director  
321.543.2498  
mike@teamlbr.com

## CHARLES DUVALL

Office Sales & Leasing  
321.722.0707 X19  
charles@teamlbr.com

## Lightle Beckner Robison, Inc.

321.722.0707 • teamlbr.com  
70 W. Hibiscus Blvd.,  
Melbourne, FL 32901

Information contained herein has been obtained through sources deemed reliable but cannot be guaranteed as to its accuracy. A purchaser or lessee is expected to verify all information to his/her own satisfaction. Zoning information subject to change and not warranted. Always confirm current requirements with local governing agencies.

# PLANS

Corporate Park at Palm Bay • 1571-1591 Robert J Conlan Blvd Palm Bay, FL 32905

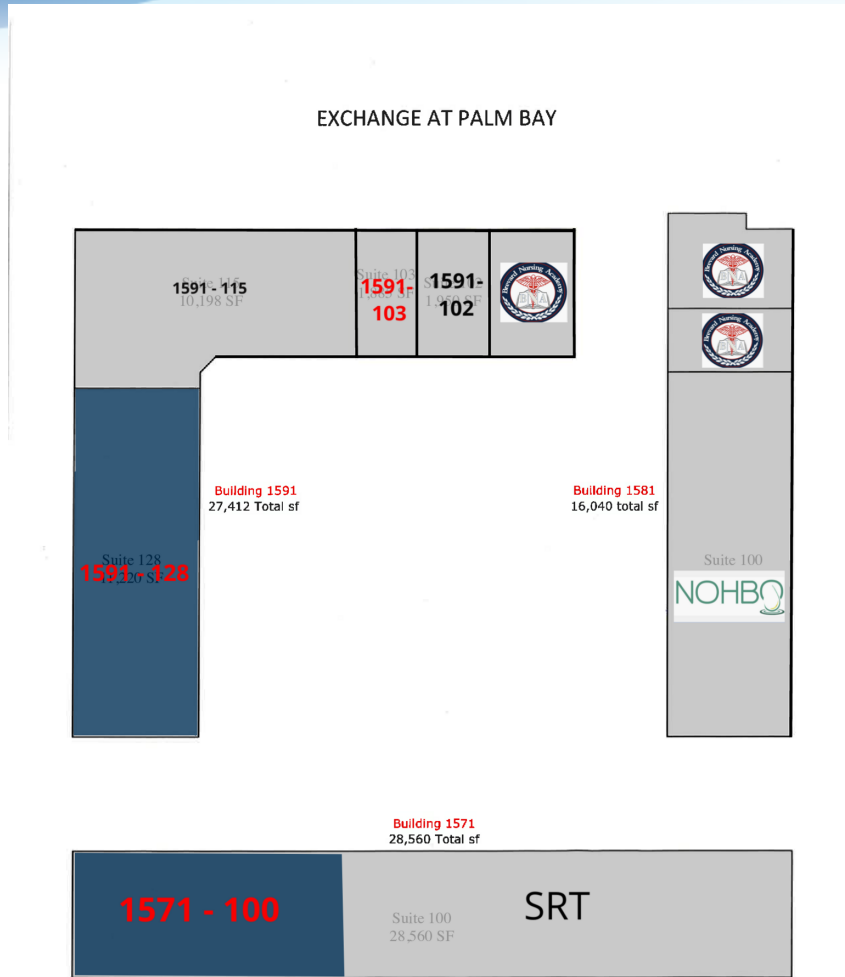

## LEGEND

Available

Unavailable

## LEASE INFORMATION

Lease Type: \$2.57 NNN Lease Term: Negotiable  
 Total Space: 10,996 - 12,560 SF Lease Rate: \$10.00 - \$12.00 SF/yr

## AVAILABLE SPACES

SUITE	SIZE	TYPE	RATE
1571 - 100	12,560 SF	\$2.57 NNN	\$10.00 - 12.00 SF/yr

### ROB BECKNER, SIOR

Principal  
321.722.0707 X11  
rob@teamlbr.com

### MIKE MOSS, SIOR

Principal | Industrial Team Director  
321.543.2498  
mike@teamlbr.com

### CHARLES DUVALL

Office Sales & Leasing  
321.722.0707 X19  
charles@teamlbr.com

### Lightle Beckner Robison, Inc.

321.722.0707 • teamlbr.com  
70 W. Hibiscus Blvd.,  
Melbourne, FL 32901

Information contained herein has been obtained through sources deemed reliable but cannot be guaranteed as to its accuracy. A purchaser or lessee is expected to verify all information to his/her own satisfaction. Zoning information subject to change and not warranted. Always confirm current requirements with local governing agencies.

# PLANS

Corporate Park at Palm Bay • 1571-1591 Robert J Conlan Blvd Palm Bay, FL 32905

SUITE	SIZE	TYPE	RATE
1591 - 128	10,996 SF	\$2.57 NNN	\$10.00 - 12.00 SF/yr

**ROB BECKNER, SIOR**

Principal  
321.722.0707 X11  
rob@teamlbr.com

**MIKE MOSS, SIOR**

Principal | Industrial Team Director  
321.543.2498  
mike@teamlbr.com

**CHARLES DUVALL**

Office Sales & Leasing  
321.722.0707 X19  
charles@teamlbr.com

**Lightle Beckner Robison, Inc.**

321.722.0707 • teamlbr.com  
70 W. Hibiscus Blvd.,  
Melbourne, FL 32901

Information contained herein has been obtained through sources deemed reliable but cannot be guaranteed as to its accuracy. A purchaser or lessee is expected to verify all information to his/her own satisfaction. Zoning information subject to change and not warranted. Always confirm current requirements with local governing agencies.

# ADDITIONAL PHOTOS

Corporate Park at Palm Bay • 1571-1591 Robert J Conlan Blvd Palm Bay, FL 32905



**ROB BECKNER, SIOR**

Principal  
321.722.0707 X11  
rob@teamlbr.com

**MIKE MOSS, SIOR**

Principal | Industrial Team Director  
321.543.2498  
mike@teamlbr.com

**CHARLES DUVALL**

Office Sales & Leasing  
321.722.0707 X19  
charles@teamlbr.com

**Lightle Beckner Robison, Inc.**

321.722.0707 • teamlbr.com  
70 W. Hibiscus Blvd.,  
Melbourne, FL 32901

Information contained herein has been obtained through sources deemed reliable but cannot be guaranteed as to its accuracy. A purchaser or lessee is expected to verify all information to his/her own satisfaction. Zoning information subject to change and not warranted. Always confirm current requirements with local governing agencies.

# ADDITIONAL PHOTOS

Corporate Park at Palm Bay • 1571-1591 Robert J Conlan Blvd Palm Bay, FL 32905



## ROB BECKNER, SIOR

Principal  
321.722.0707 X11  
rob@teamlbr.com

## MIKE MOSS, SIOR

Principal | Industrial Team Director  
321.543.2498  
mike@teamlbr.com

## CHARLES DUVALL

Office Sales & Leasing  
321.722.0707 X19  
charles@teamlbr.com

## Lightle Beckner Robison, Inc.

321.722.0707 • teamlbr.com  
70 W. Hibiscus Blvd.,  
Melbourne, FL 32901

Information contained herein has been obtained through sources deemed reliable but cannot be guaranteed as to its accuracy. A purchaser or lessee is expected to verify all information to his/her own satisfaction. Zoning information subject to change and not warranted. Always confirm current requirements with local governing agencies.

# LOCATION MAPS

Corporate Park at Palm Bay • 1571-1591 Robert J Conlan Blvd Palm Bay, FL 32905

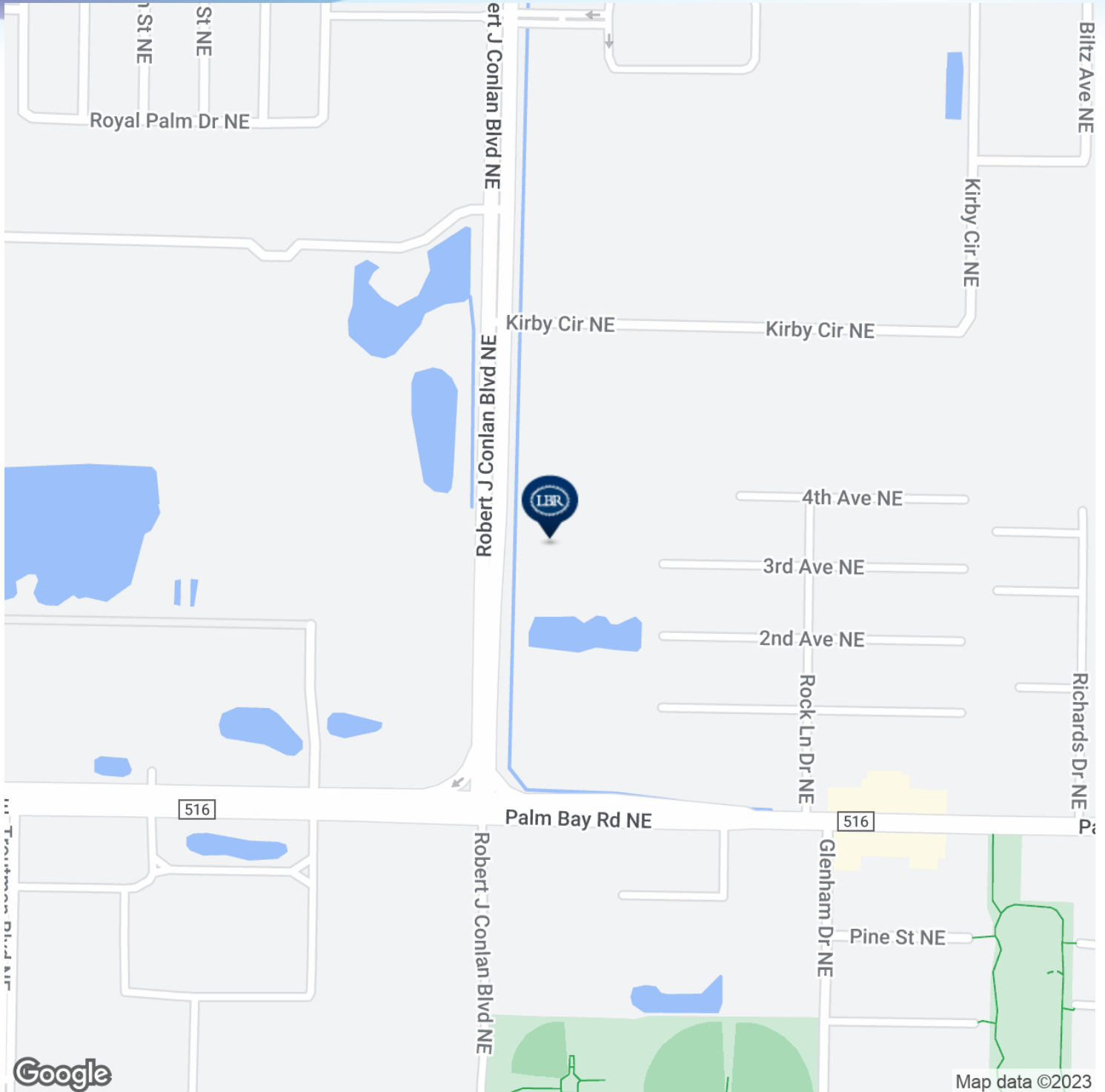

## ROB BECKNER, SIOR

Principal  
321.722.0707 X11  
rob@teamlbr.com

## MIKE MOSS, SIOR

Principal | Industrial Team Director  
321.543.2498  
mike@teamlbr.com

## CHARLES DUVALL

Office Sales & Leasing  
321.722.0707 X19  
charles@teamlbr.com

## Lightle Beckner Robison, Inc.

321.722.0707 • teamlbr.com  
70 W. Hibiscus Blvd.,  
Melbourne, FL 32901

Information contained herein has been obtained through sources deemed reliable but cannot be guaranteed as to its accuracy. A purchaser or lessee is expected to verify all information to his/her own satisfaction. Zoning information subject to change and not warranted. Always confirm current requirements with local governing agencies.