

RARE Automotive/Industrial for \$2,848,000

2416 Whipple Road, Hayward, CA 94544



High Visibility Corner



Perfect for Owner User

Renz & Renz
Local Roots; National Reach



Exclusively Listed By



GEORGE L. RENZ, CCIM, SIOR, ALC
Renz & Renz Investment & Commercial Brokerage
408-846-1031 office | 408-846-1042 fax
george@renzrenz.com
BRE License # 00854816

Hayward Industrial

2416 Whipple Road, Hayward, CA 94544

List Price	\$2,848,000
Zoning	IL: Light Industrial
Lot Size	15,600 SqFt
Building Size	7,111 SqFt
Year Built	1981

Property Highlights

- Would Suit Owner-User (Delivered Vacant at Close)
- High traffic count: 21,880 on Whipple Rd & 217,000 on Hwy 880
- Medium sized Corner Industrial
- Property has its own off-street parking: 15 spaces
- Building: 4 auto bays/grade level doors, reception area, lobby, break room, and bathroom.







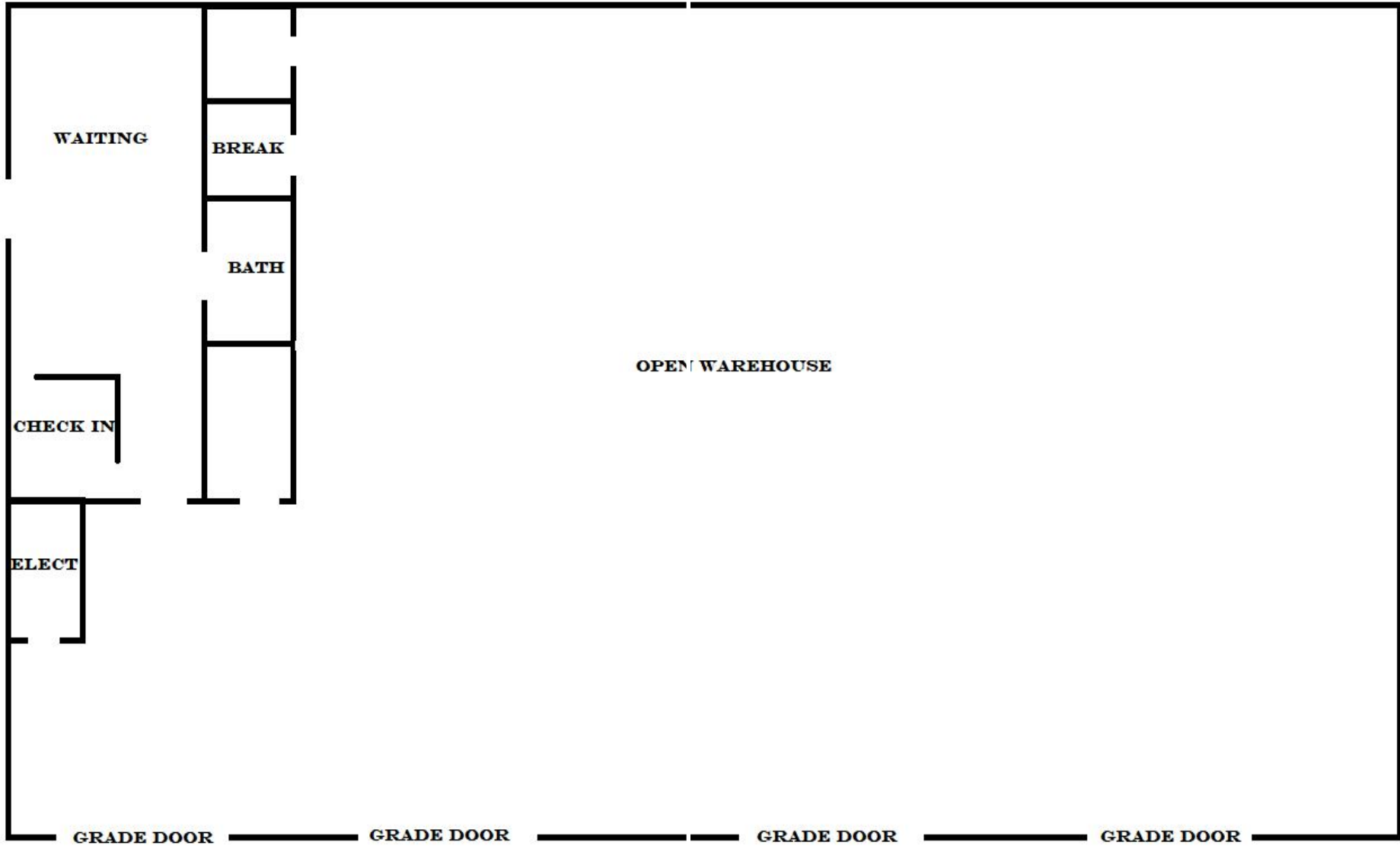

*All measurements are estimated. Drawing is not to scale. All information provided to be independently certified.

Population

2010	144,581
2023	163,369
2028 (projected)	163,893

Households

2010	45,479
2023	50,541
2028 (projected)	50,848
2023 Average Size	3.17

2023 Households Income

Median Income	\$113,834
Average Income	\$159,168
Per Capita Income	\$49,421



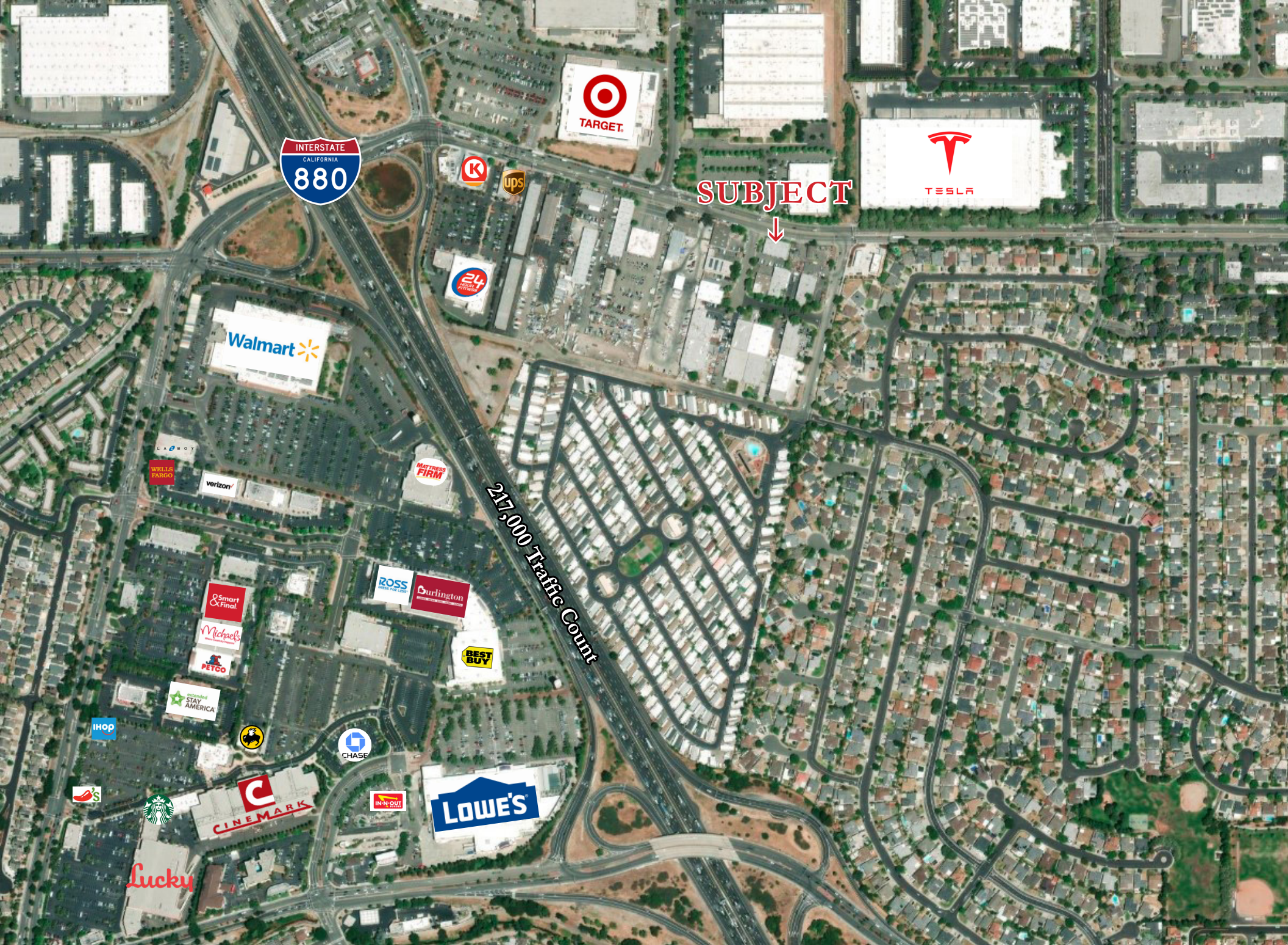

INTERSTATE CALIFORNIA 880

TARGET

TESLA

SUBJECT

Walmart

24 HOURS

WELLS FARGO

verizon

MATRESS FIRM

217,000 Traffic Count

ROSS

Durlington

BEST BUY

Smart & Final

Michael's

PETCO

STAY AMERICA

IHOP

CHASE

CINEMARK

LOWE'S

IN-N-OUT

Lucky

DISCLOSURE & NON-DISCLOSURE

Information contained herein was obtained from the owner or sources we deem reliable. We have no reason to doubt its accuracy, but do not guarantee it. Prospective buyers should investigate and verify all information pertaining to the property. Recievers of this information commit to using it solely for it's purpose and not to disseminate Seller or Tenant information for any other use.



Exclusively Listed By



George L. Renz, CCIM, SIOR, ALC
President
408.846.1031
george@renzrenz.com
BRE Lic: 008545816

