

# OFFICE | WAREHOUSE CONDO

FOR **SALE**

3933 NW 126th Ave, Coral Springs, FL 33065

**1,956** ± SQ FT

**OFF MARKET**



- Zoned IRD - Industrial Park
- 2-story Industrial-Business Park Condo
- Roll-Up Garage Door 12'H x 10'W Elec Motor
- Impact Windows & Doors
- 22' Clear Ceiling Height
- Legal Mezzanine with Windows
- 20% Office Build Out
- Next to Sawgrass Expressway

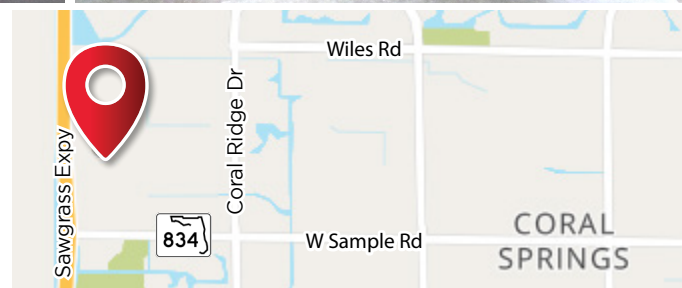

**\$580,000**



**JOE PELAYO, CCIM, SIOR**  
 BROKER  
 trec@joepelayo.com  
**954.224.8773**

**TREC**  
 Total Real Estate  
 Consultants Inc.  
 www.trecfl.com

**GEORGE PELAYO, RENE, MRP**  
 BROKER ASSOCIATE  
 georgetrec@joepelayo.com  
**954.482.1330**



COMMERCIAL REAL ESTATE

**954.341.3294**

*Note: This offering subject to errors, omissions, prior sales or withdrawal without notice.*

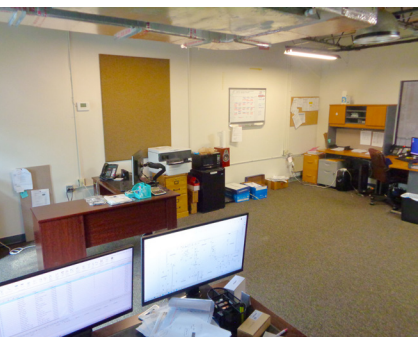

3933 NW 126th Ave, Coral Springs, FL 33065  
FLOORPLAN

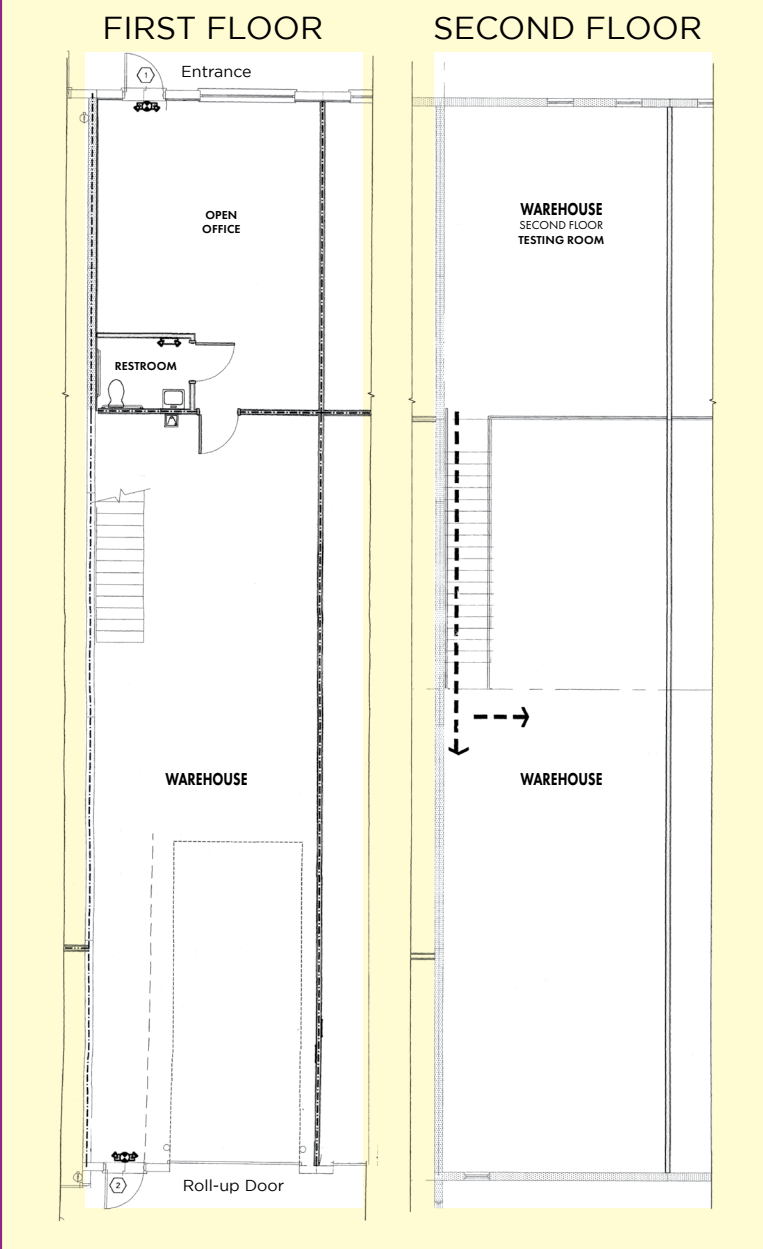

**JOE PELAYO, CCIM, SIOR**  
BROKER  
trec@joepelayo.com  
**954.224.8773**

**TREC**  
Total Real Estate  
Consultants Inc.  
www.trecfl.com

**GEORGE PELAYO, RENE, MRP**  
BROKER ASSOCIATE  
georgetrec@joepelayo.com  
**954.482.1330**

