



**PROPERTY HIGHLIGHTS**

- Available SF: Bay 3340/3350 is 17,040 +/- SF
- Lease Rate: Upon request
- 2023 Estimated OPEX: \$3.07 psf
- Bay 3340/3350 has three (3) dock and one (1) grade level loading doors
- Space has about 1,500 SF of office space
- Warehouse doors are 10'0" wide by 14'0" tall
- Ceiling height is 20' clear
- The bay has 3 Phase Power
- One of a kind location with excellent access to I-95, I-595, Florida Turnpike, Fort Lauderdale Hollywood International Airport and Port Everglades.

For more information:

**Jonathan Thiel**

954.652.2020 | [Jthiel@Bergercommercial.Com](mailto:Jthiel@Bergercommercial.Com)  
[bergercommercial.com](http://bergercommercial.com)

**St. George Guardabassi**

954.652.2032 | [St.George@Bergercommercial.Com](mailto:St.George@Bergercommercial.Com)



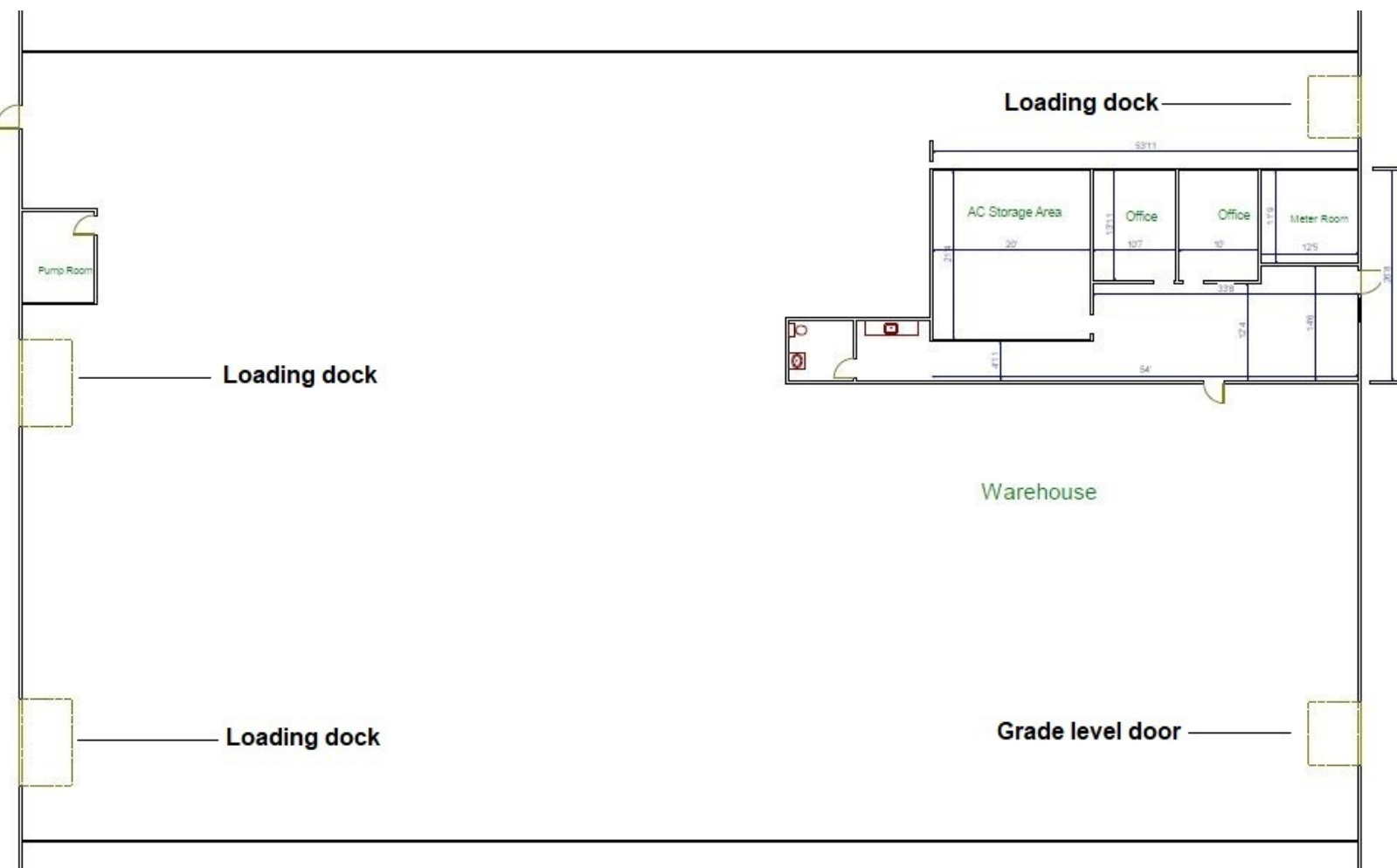

For more information:

**Jonathan Thiel**

954.652.2020 | [Jthiel@Bergercommercial.Com](mailto:Jthiel@Bergercommercial.Com)  
[bergercommercial.com](http://bergercommercial.com)

**St. George Guardabassi**

954.652.2032 | [St.George@Bergercommercial.Com](mailto:St.George@Bergercommercial.Com)



# SCHAEFER INDUSTRIAL PARK

# LOCATION MAP

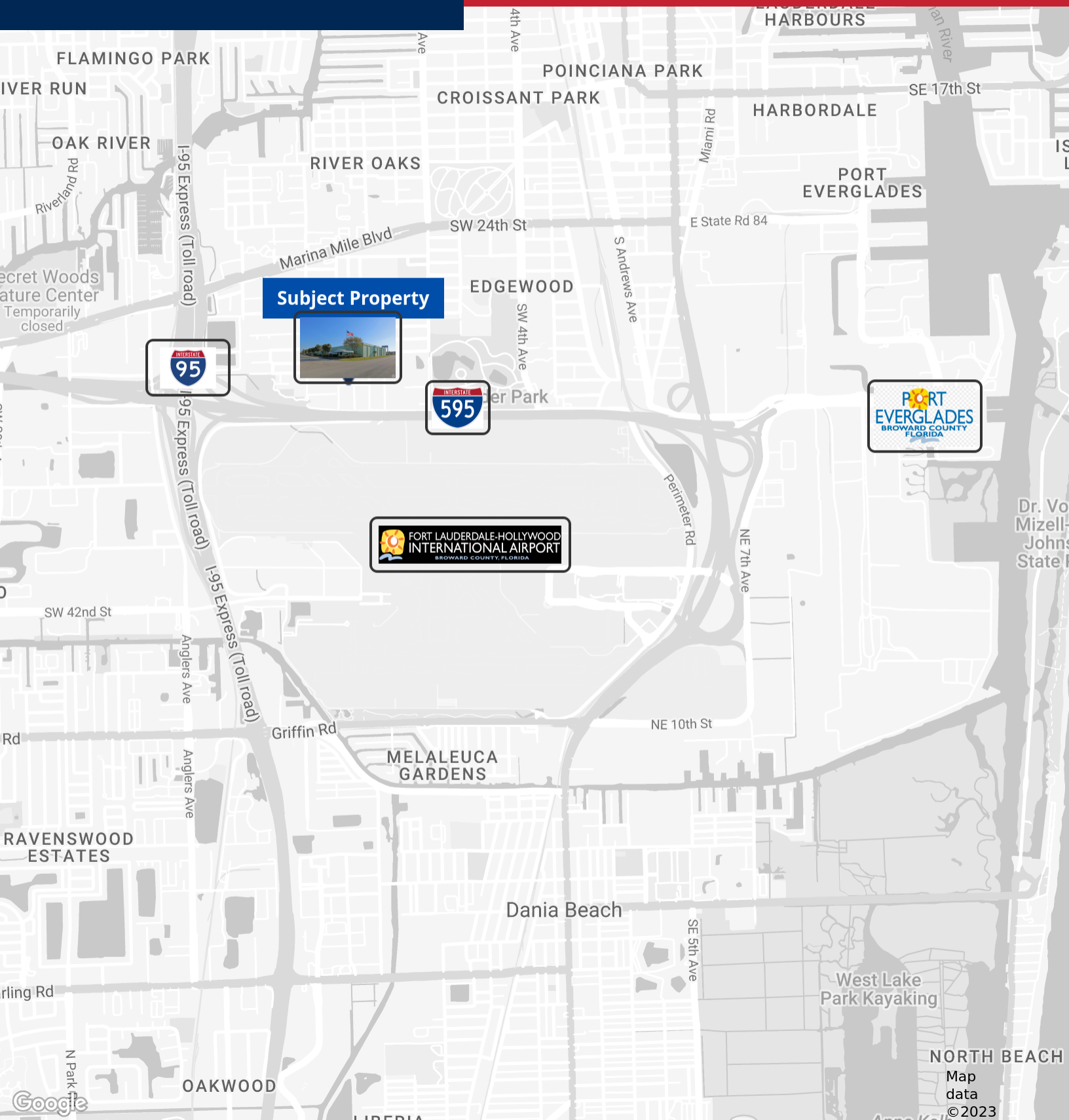

For more information:

**Jonathan Thiel**

954.652.2020 | [Jthiel@Bergercommercial.com](mailto:Jthiel@Bergercommercial.com)  
[bergercommercial.com](http://bergercommercial.com)

**St. George Guardabassi**

954.652.2032 | [St.George@Bergercommercial.com](mailto:St.George@Bergercommercial.com)

