

Impeccably Maintained Office Condo For Sale \$310,000 for Sale In Duval Court

665 SE 10 St. #102
Deerfield Beach, FL 33441



FOR SALE	835 Sq. Ft. Office Condo		
DESCRIPTION	PRICE REDUCED!! One of the lowest priced office condos in Broward County!! Located in the highly desirable Duval Professional Centre. Centrally located with easy access to I-95, Sawgrass Expressway and FL Turnpike. This office condo contains 4 offices, 2 separate bathrooms, kitchen area with ample storage area and impact windows and doors. Affordably priced for the buyer seeking good visibility and high income demographics.		
PROPERTY VIDEO	https://www.youtube.com/embed/UjzZT2nWB-M?rel=0		
LOCATION	Located in Duval Court at the Northwest Corner of Federal Hwy and SE 10 th Street.		
PARKING/ YEAR BUILT	4 Parking Spaces Built in 2006.		
PRICING	\$310,000 Price per sq. ft. \$371.26. Condo fees \$432.42 per month.		
ZONING/FOLIO	B1 4843-06-AM-0020		
Traffic Count	25,270 Cars per Day SE 10 Street		
DEMOGRAPHICS 2022		1 mile	3 mile
	HH Population:	17,622	114,145
	Average HH Income:	\$82,028	\$87,657
			5 mile
			231,393
			\$88,805

Disclaimer: This offering subject to errors, omissions, prior sale or withdrawal without notice.

CAMPBELL & ROSEMURGY
COMMERCIAL REAL ESTATE

FOR MORE INFORMATION:

John D. McQueston

john@johnmcqueston.com • 561-706-7721 (cell)

www.johnmcqueston.com

1233 E. Hillsboro Blvd
Deerfield Beach, FL 33441

954.427.8686 T.
954.427.0117 F.

Location Map

For Sale \$310,000

665 SE 10 St. #102

Deerfield Beach, FL 33441

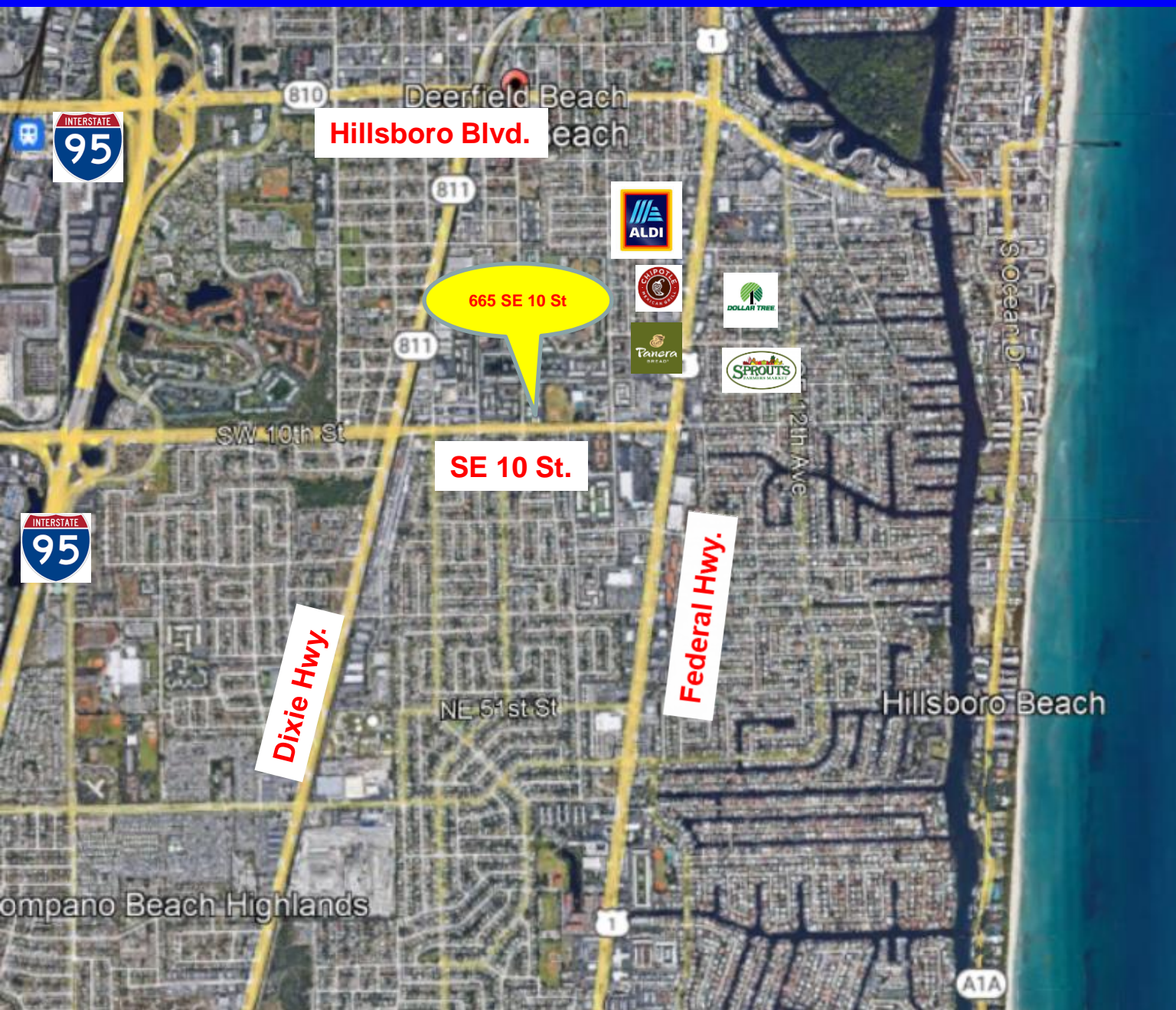

Disclaimer: This offering subject to errors, omissions, prior sale or withdrawal without notice.

CAMPBELL & ROSEMURGY
COMMERCIAL REAL ESTATE

FOR MORE INFORMATION:

John D. McQuestion

john@johnmcquestion.com • 561-706-7721 (cell)

www.johnmcquestion.com

1233 E. Hillsboro Blvd
Deerfield Beach, FL 33441

954.427.8686 T.
954.427.0117 F.

Additional Photos

For Sale \$310,000

665 SE 10 St. #102

Deerfield Beach, FL 33441

Street Entrance



Entrance/ Waiting Area



Aerial View



Monument Signage



Disclaimer: This offering subject to errors, omissions, prior sale or withdrawal without notice.

CAMPBELL & ROSEMURGY
COMMERCIAL REAL ESTATE

FOR MORE INFORMATION:

John D. McQuestion

john@johnmcquestion.com • 561-706-7721 (cell)

www.johnmcquestion.com

1233 E. Hillsboro Blvd
Deerfield Beach, FL 33441

954.427.8686 T.
954.427.0117 F.

Property Dimensions Floorplan

For Sale \$310,000

665 SE 10 St. #102

Deerfield Beach, FL 33441

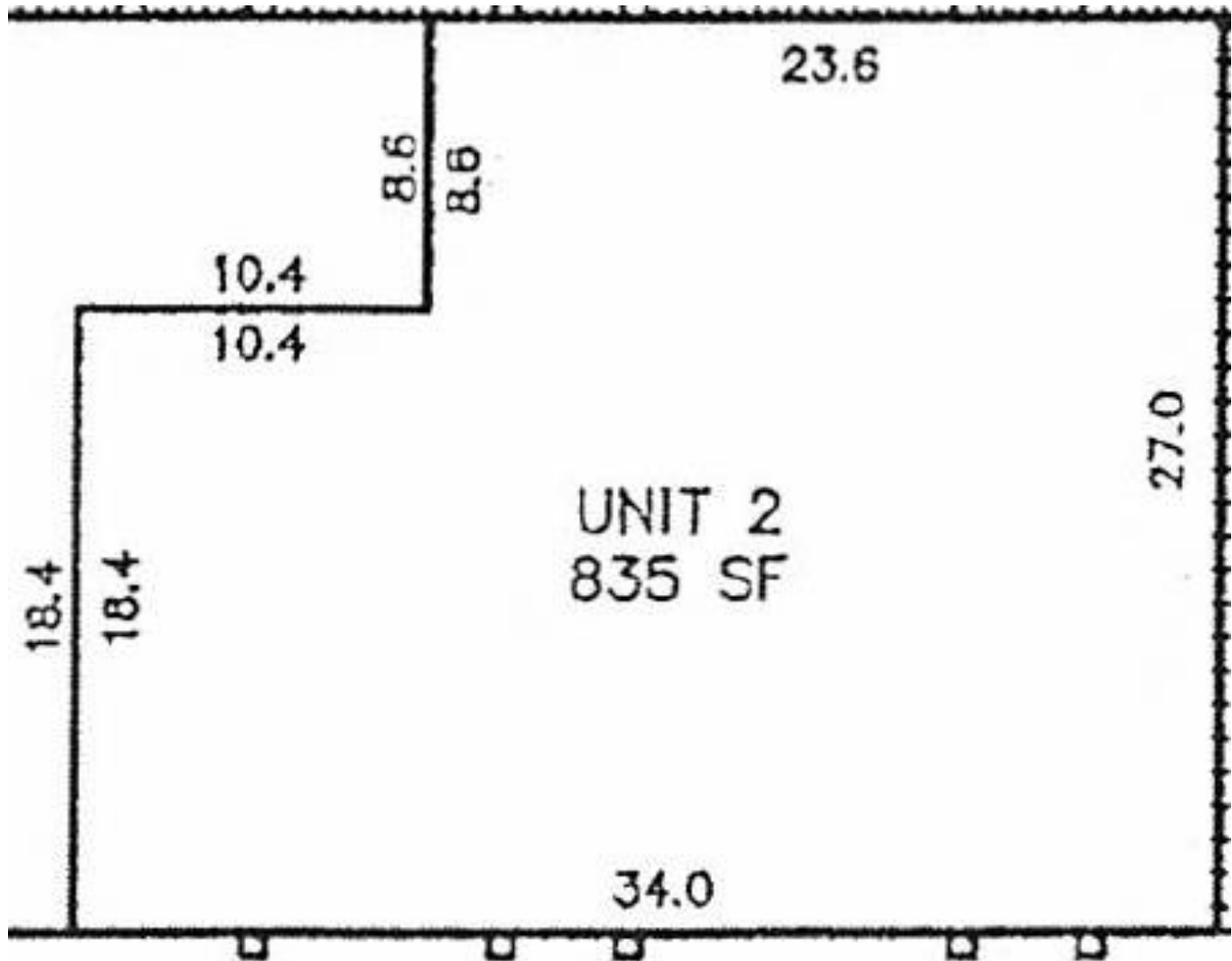

Disclaimer: This offering subject to errors, omissions, prior sale or withdrawal without notice.

CAMPBELL & ROSEMURGY
COMMERCIAL REAL ESTATE

FOR MORE INFORMATION:

John D. McQuestion

john@johnmcquestion.com • 561-706-7721 (cell)

www.johnmcquestion.com

1233 E. Hillsboro Blvd
Deerfield Beach, FL 33441

954.427.8686 T.
954.427.0117 F.