



For Lease

1131 N STATE ROAD 7
ROYAL PALM BEACH, FLORIDA



Proposed Rendering

New Class 'A' Distribution
Warehouse in Royal Palm Beach



Connecting your business to what matters to you most.

Royal Palm Logistics is located in Royal Palm Beach, Florida in close proximity to West Palm Beach. Ideally positioned on 441 with easy access to I-95 and the FL Turnpike via Okeechobee Boulevard.

Main Florida Ports

Miami	Miami Int'l Airport	70.2 miles	Port of Miami	71.5 miles
Fort Lauderdale	Fort Lauderdale-Hollywood Int'l Airport	53.6 miles	Port Everglades	49.6 miles
West Palm Beach	Palm Beach Int'l Airport	8.8 miles	Port of Palm Beach	14.4 miles
Naples	Naples Municipal Airport	138 miles	Port of Naples	139 miles
Fort Myers	Southwest Florida Int'l Airport	126 miles		
Tampa	Tampa Int'l Airport	213 miles	Port Tampa Bay	206 miles
Orlando	Orlando Int'l Airport	165 miles	Port Canaveral	145 miles
Jacksonville	Jacksonville Int'l Airport	294 miles	Jaxport	284 miles

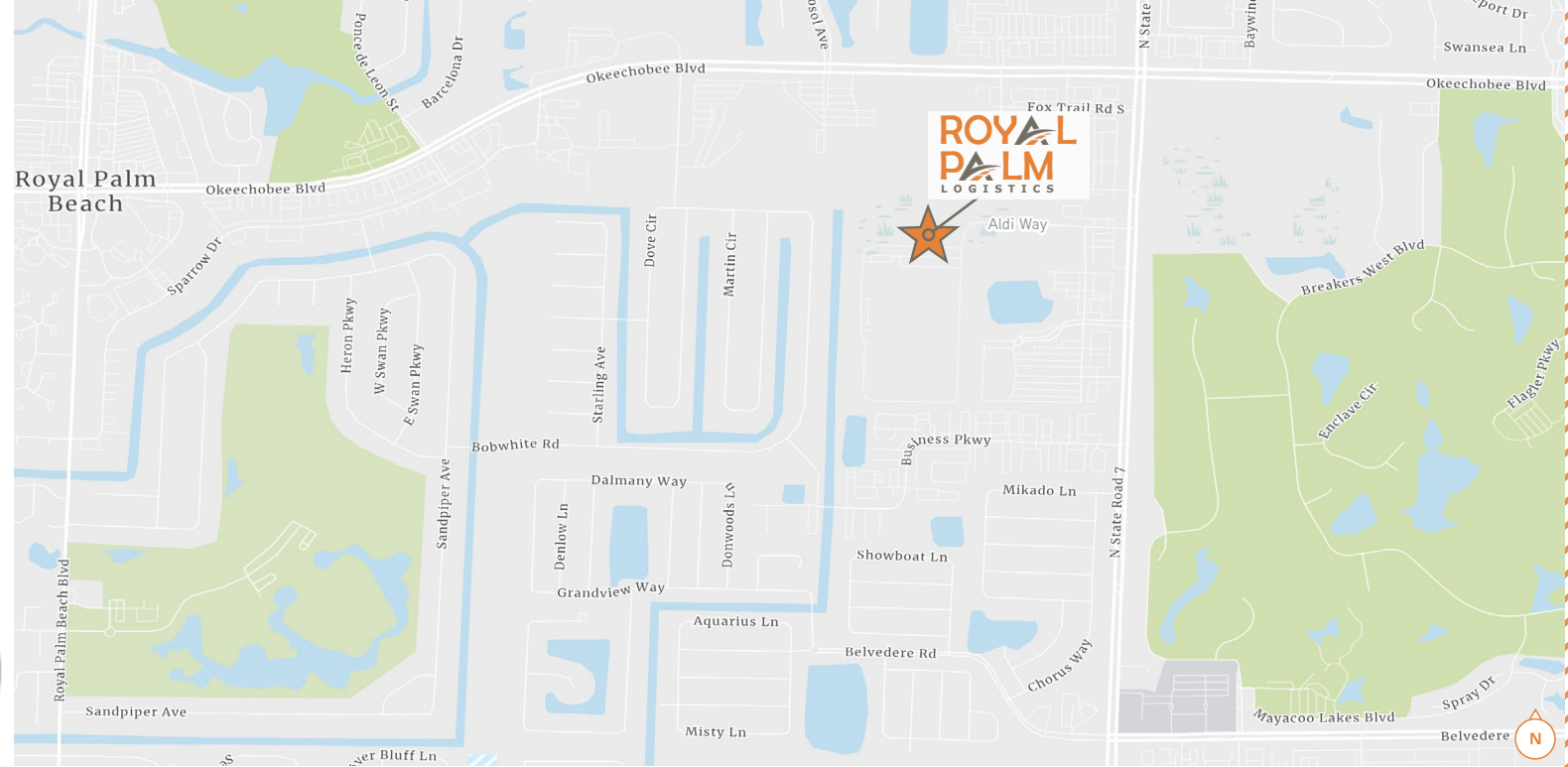
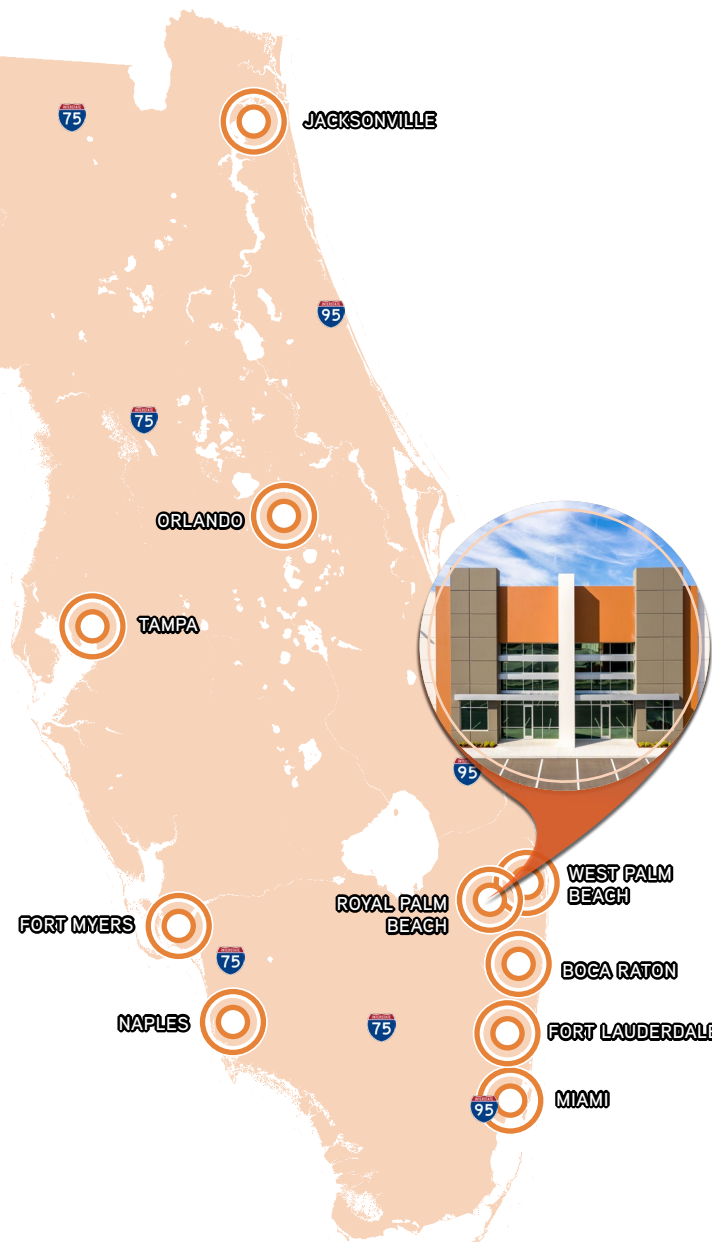

Property Highlights

- Building - 128,684 SF
Units starting at ±26,628 SF
- 32' Clear Ceiling Heights
- Easy Highway Access via Okeechobee Blvd
- Dock High & Grade Level Loading
- ESFR Sprinkler System
- Projected Occupancy of Early 2023

Site Plan

Click to view larger plan

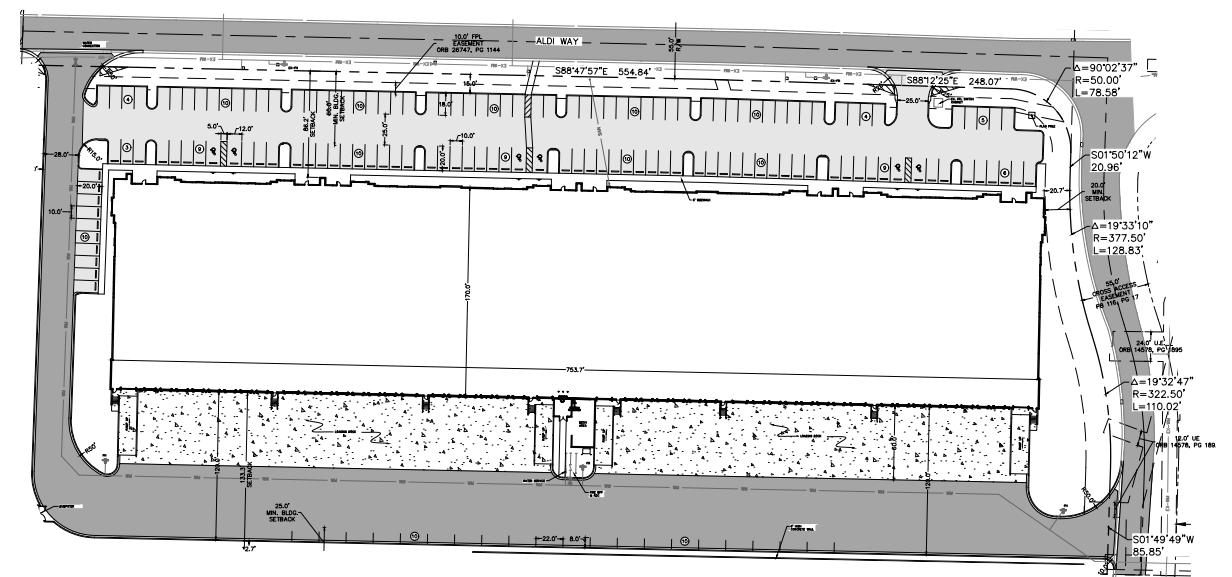



ROYAL PALM LOGISTICS

CONTACT US.

Michael Falk, SIOR CCIM
Executive Vice President
+1 561 662 2624
michael.falk@colliers.com

Scott Weprin
Executive Vice President
+1 561 239 9386
scott.weprin@colliers.com

Jason Weprin
Senior Associate
+1 561 558 7709
jason.weprin@colliers.com

Colliers International Florida, LLC | 901 Northpoint Parkway, Suite 109, West Palm Beach, FL 33407

This document has been prepared by Colliers International for advertising and general information only. Colliers International makes no guarantees, representations or warranties of any kind, expressed or implied, regarding the information including, but not limited to, warranties of content, accuracy and reliability. Any interested party should undertake their own inquiries as to the accuracy of the information. Colliers International excludes unequivocally all inferred or implied terms, conditions and warranties arising out of this document and excludes all liability for loss and damages arising there from. This publication is the copyrighted property of Colliers International and/or its licensor(s). ©2023. All rights reserved.

Rev: 01.31.23

RoyalPalmLogistics.com

