

Proposed Development Opportunity

224-230 EAST MAIN ST., CLINTON, CT



FOR LEASE
Call Agent
For Details

Development Plan

- 12,900 SF Retail Space
- Next to New 3,295 SF Bank
- Acres: 3.1122
- Traffic Count: 10,200
- Frontage: 300 Ft.
- Abutter is Walgreens
- Signalized Intersection
- Zone: B-4

Business District

Demographics	1 MILE	3 MILES	5 MILES
Total Population	3283	13,295	27,502
Households	1,509	5,662	11,330
Average Household Income	\$87,177	\$95,978	\$109,287

LYMAN

REAL ESTATE BROKERAGE & DEVELOPMENT

www.LymanRE.com

RON LYMAN

Main Office:
 1160 Boston Post Rd.
 Westbrook, CT 06498
 Mailing Address:
 73 Second Ave.
 Westbrook, CT 06498
 860-887-5000 Office
ronl@lymanre.com

Proposed Development

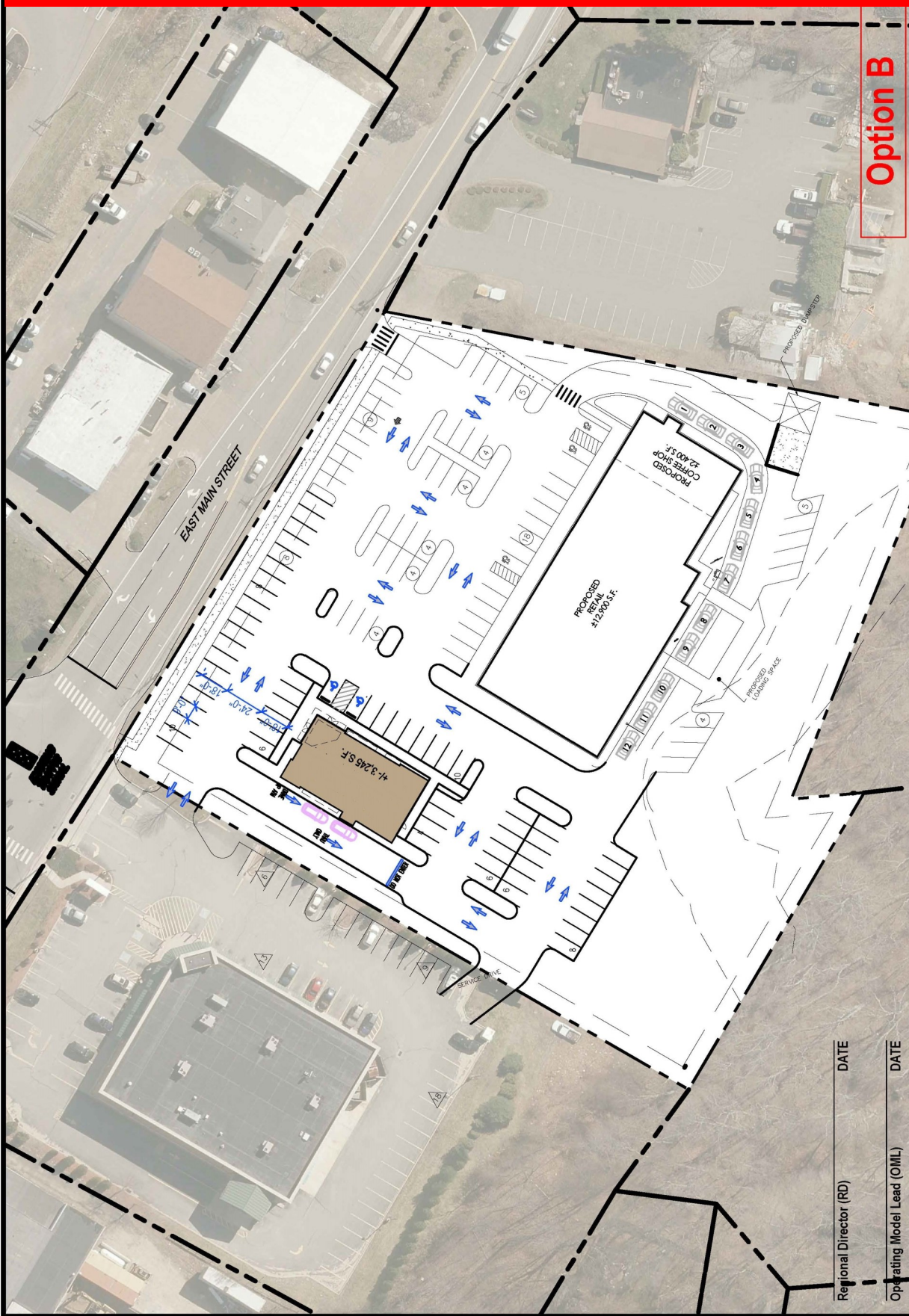

Option B

DATE	DESIGNER	AREA	SCALE
10/05/2022	ML		NONE



Site Test Fit
CLINTON EAST MAIN
 CLINTON, CT

Regional Director (RD) _____ DATE _____
 Operating Model Lead (OML) _____ DATE _____