

We know this land.

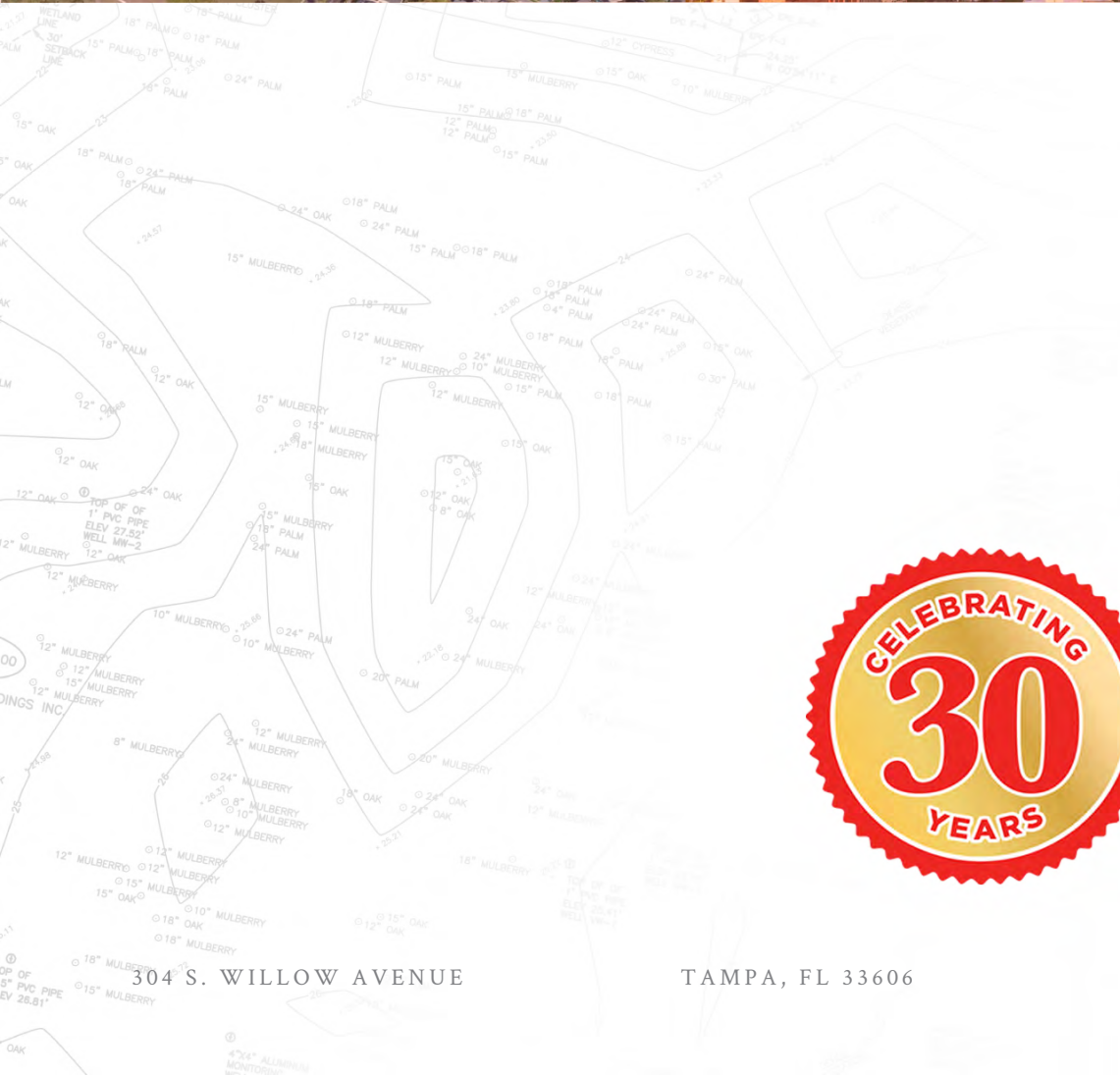

Eshenbaugh
LAND COMPANY

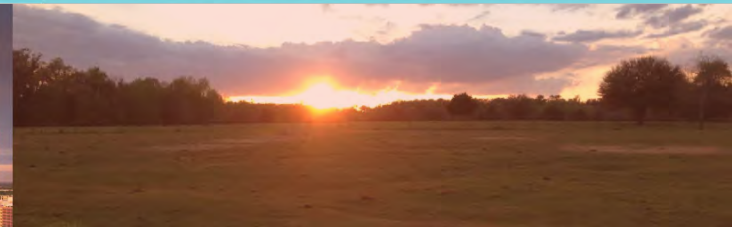
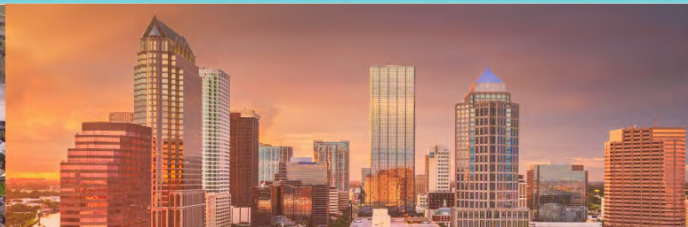

The Dirt Dog

304 S. WILLOW AVENUE

TAMPA, FL 33606

813.287.8787

www.thedirtdog.com

Building Photo



Property Description

PROPERTY DESCRIPTION

This 6,042 SF building is available in the Cedarbrook Community in Riverview, FL. It is zoned PD with potential plans for commercial, office or daycare. The building shell was recently completed and is available for a buyer to complete the buildout of the building to accommodate their needs.

LOCATION DESCRIPTION

The site is located off of Willow Grove Drive in the large Cedarbrook Community adjacent to the community's clubhouse. The subdivision is east of US 301 and south of Rhodine Rd in Riverview, FL.

PROPERTY SIZE

0.27 Acres

ZONING

PD

PARCEL ID

077426-0217

PROPERTY OWNER

Rhodine Holdings LLC

PRICE

\$750,000

BROKER CONTACT INFO

Chris Bowers, CCIM

Senior Broker

813.287.8787 x8

chris@thedirt dog.com

Building Photo



Aerials (cont.)



Aerial



Photos Of The Inside



Photos Of The Inside



Photos Of The Inside



Conceptual Site Plan



Demographics Map & Report

POPULATION

	1 MILE	3 MILES	5 MILES
Total Population	2,173	38,710	120,035
Average Age	37.0	37.0	37.4
Average Age (Male)	38.3	36.0	36.2
Average Age (Female)	36.5	37.7	38.2

HOUSEHOLDS & INCOME

	1 MILE	3 MILES	5 MILES
Total Households	666	13,374	42,081
# of Persons per HH	3.3	2.9	2.9
Average HH Income	\$89,030	\$94,582	\$96,658
Average House Value	\$202,462	\$259,097	\$254,284

* Demographic data derived from 2020 ACS - US Census

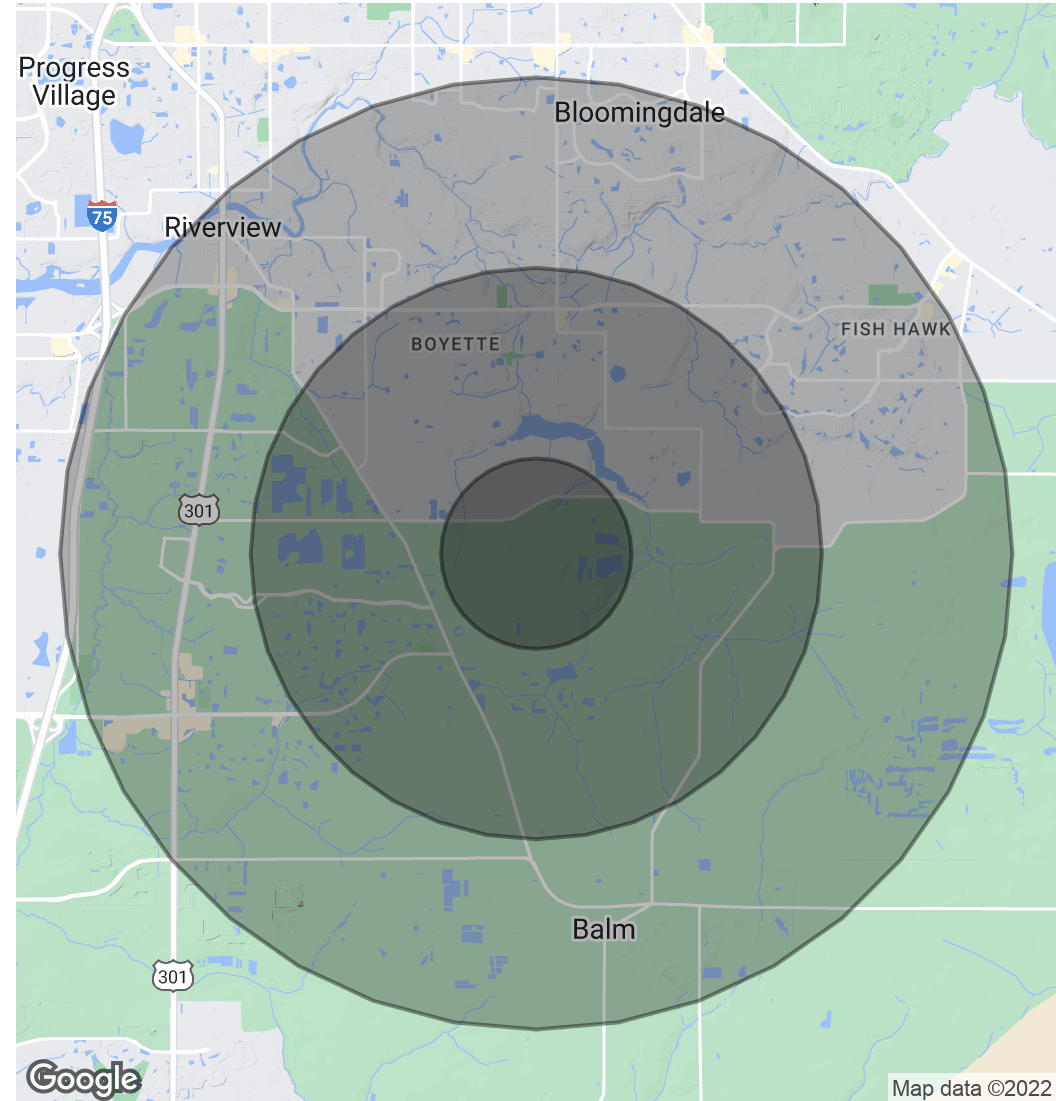

Location Map

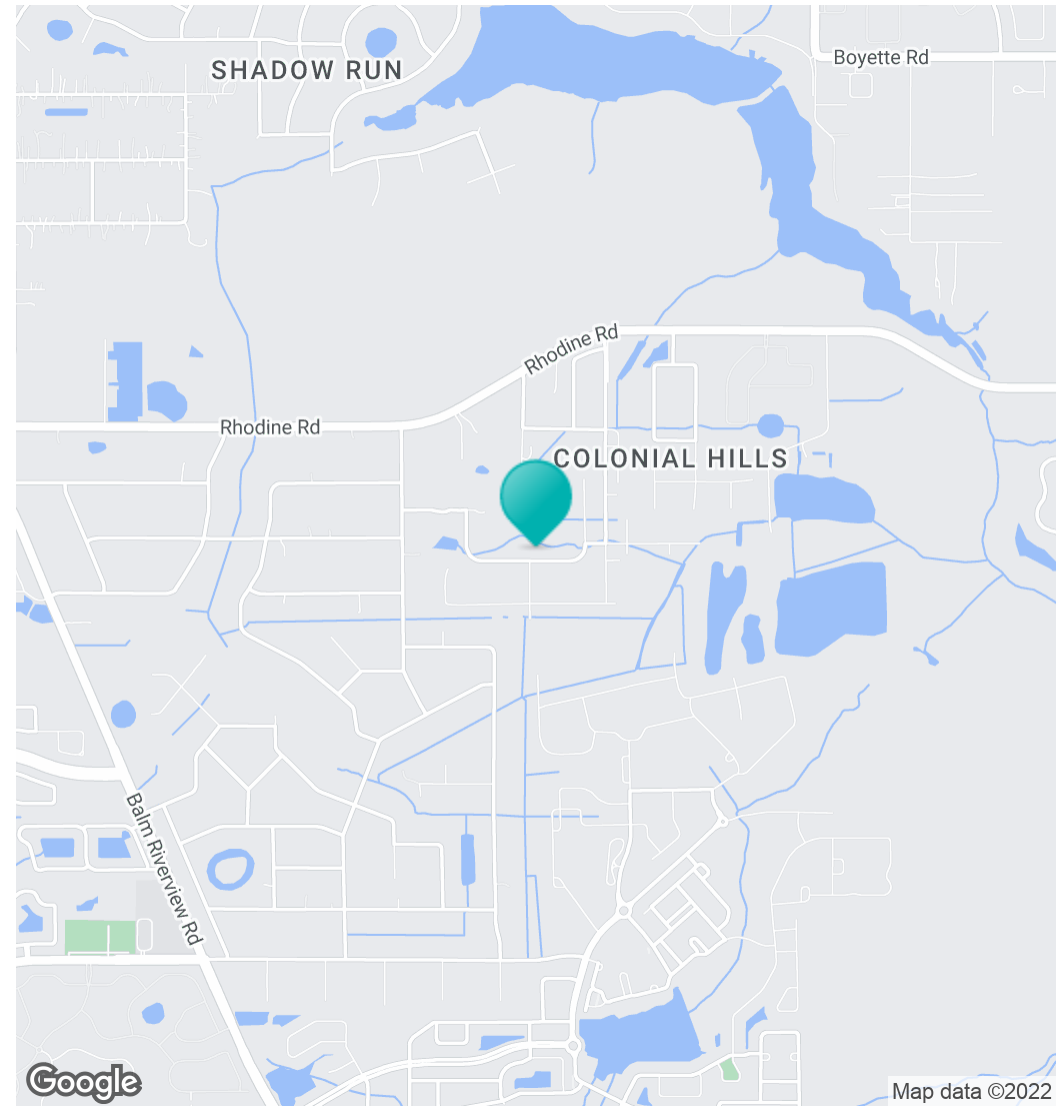
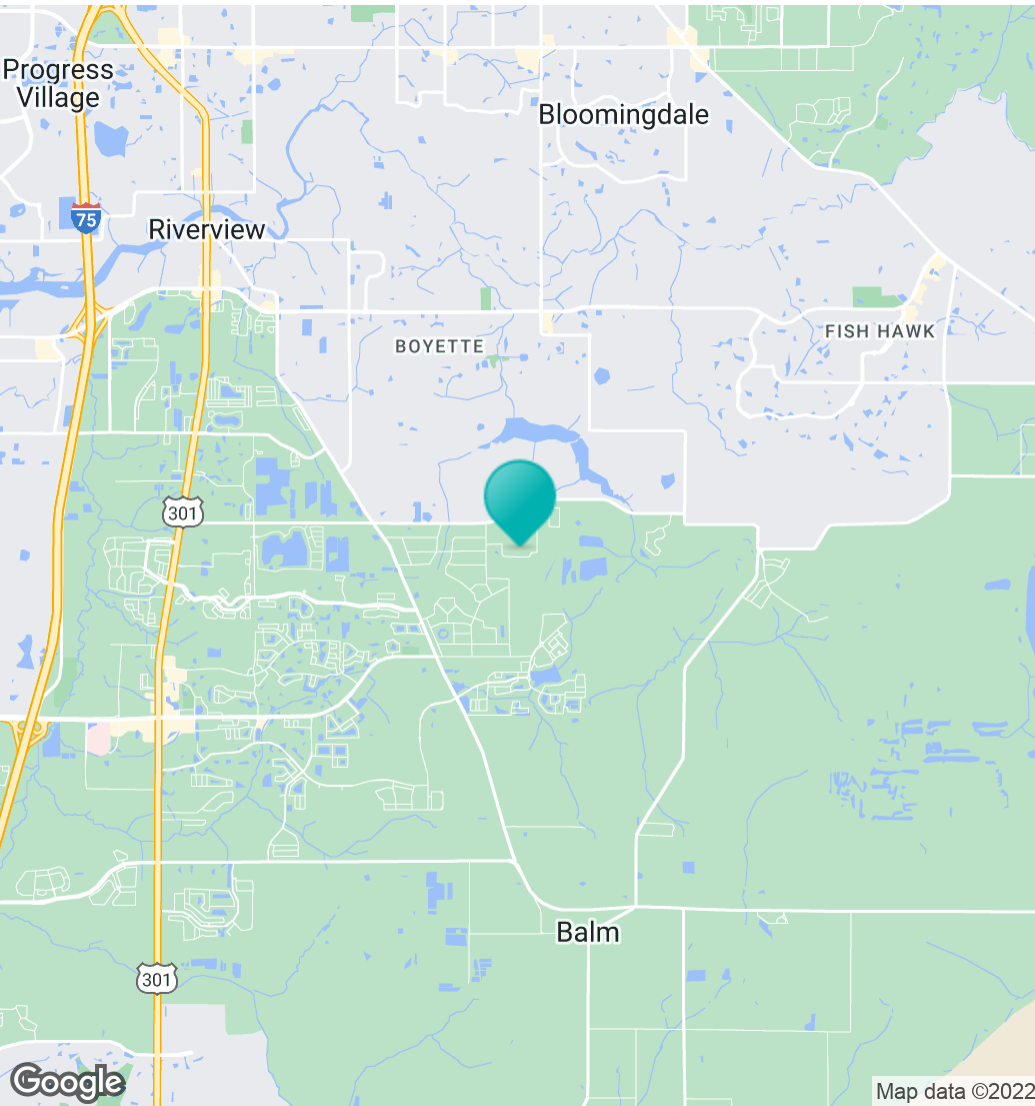

Confidentiality & Disclaimer

All materials and information received or derived from Eshenbaugh Land Company, LLC its directors, officers, agents, advisors, affiliates and/or any third party sources are provided without representation or warranty as to completeness, veracity, or accuracy, condition of the property, compliance or lack of compliance with applicable governmental requirements, developability or suitability, financial performance of the property, projected financial performance of the property for any party's intended use or any and all other matters.

Neither Eshenbaugh Land Company, LLC its directors, officers, agents, advisors, or affiliates makes any representation or warranty, express or implied, as to accuracy or completeness of the any materials or information provided, derived, or received. Materials and information from any source, whether written or verbal, that may be furnished for review are not a substitute for a party's active conduct of its own due diligence to determine these and other matters of significance to such party. Eshenbaugh Land Company, LLC will not investigate or verify any such matters or conduct due diligence for a party unless otherwise agreed in writing. EACH PARTY SHALL CONDUCT ITS OWN INDEPENDENT INVESTIGATION AND DUE DILIGENCE.

Any party contemplating or under contract or in escrow for a transaction is urged to verify all information and to conduct their own inspections and investigations including through appropriate third party independent professionals selected by such party. All financial data should be verified by the party including by obtaining and reading applicable documents and reports and consulting appropriate independent professionals. Eshenbaugh Land Company, LLC makes no warranties and/or representations

regarding the veracity, completeness, or relevance of any financial data or assumptions. Eshenbaugh Land Company, LLC does not serve as a financial advisor to any party regarding any proposed transaction. All data and assumptions regarding financial performance, including that used for financial modeling purposes, may differ from actual data or performance. Any estimates of market rents and/or projected rents that may be provided to a party do not necessarily mean that rents can be established at or increased to that level. Parties must evaluate any applicable contractual and governmental limitations as well as market conditions, vacancy factors and other issues in order to determine rents from or for the property.

Legal questions should be discussed by the party with an attorney. Tax questions should be discussed by the party with a certified public accountant or tax attorney. Title questions should be discussed by the party with a title officer or attorney. Questions regarding the condition of the property and whether the property complies with applicable governmental requirements should be discussed by the party with appropriate engineers, architects, contractors, other consultants and governmental agencies. All properties and services are marketed by Eshenbaugh Land Company, LLC in compliance with all applicable fair housing and equal opportunity laws.

Eshenbaugh Land Company is a licensed real estate brokerage firm in Florida and William A. Eshenbaugh is the broker of record.