

# 3rd Gen Machine



Presented By:  
Parker Real Estate Services

1435 N 200 W, Logan, UT 84341



# 3rd Gen Machine

1435 N 200 W, Logan, UT 84341

## Property Details

**Price: \$3,000,000**

- 1,000 amps 208 V 3 Phase Power
- Fully Functioning Machine shop
- Large Fully fenced yard

View the full listing here: <https://www.loopnet.com/Listing/1435-N-200-W-Logan-UT/24505940/>

Price:	\$3,000,000
Property Type:	Industrial
Property Subtype:	Warehouse
Building Class:	B
Sale Type:	Owner User
Lot Size:	2.97 AC
Rentable Building Area	12,600 SF
:	
Rentable Building Area	12,600 SF
:	
No. Stories:	1
Year Built:	1994
Tenancy:	Single
Parking Ratio:	6.03/1,000 SF
No. Drive In / Grade-Level Doors	5
:	
Zoning Description:	CS
APN / Parcel ID:	04-082-0009

# 3rd Gen Machine

1435 N 200 W, Logan, UT 84341

## Location

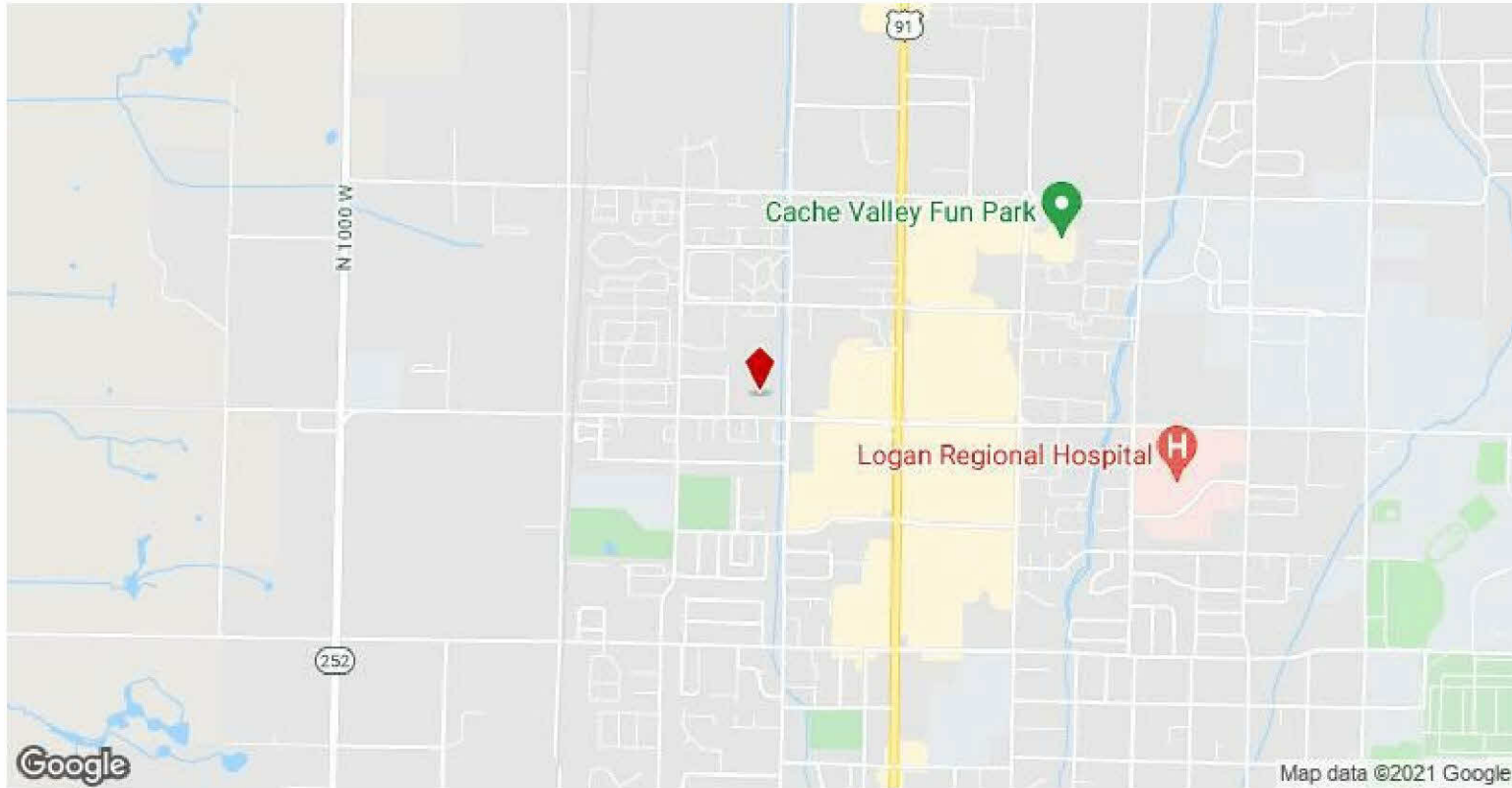

# 3rd Gen Machine

1435 N 200 W, Logan, UT 84341

## Property Photos



Primary Photo



Aerial

# 3rd Gen Machine

1435 N 200 W, Logan, UT 84341

## Property Photos



Building Photo



IMG\_6290

# 3rd Gen Machine

1435 N 200 W, Logan, UT 84341

## Property Photos



IMG\_6291



IMG\_6293

# 3rd Gen Machine

1435 N 200 W, Logan, UT 84341

## Property Photos

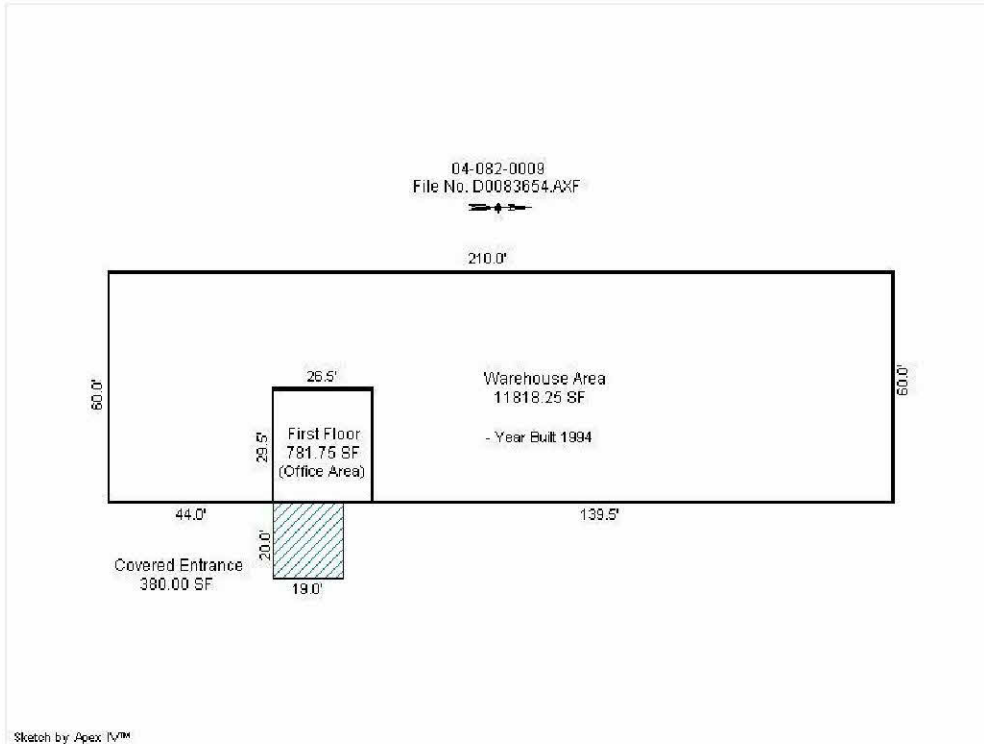

Site Plan

# 3rd Gen Machine

For more listing information visit:  
<https://www.loopnet.com/Listing/1435-N-200-W-Logan-UT/24505940/>

1435 N 200 W, Logan, UT 84341



**Blake Parker**

[blakebparker@gmail.com](mailto:blakebparker@gmail.com)

(435) 755-9900 Ext: 208

**Parker Real Estate  
Services**

45 E 200 N, Suite 200  
Logan, UT 84321

