

WAREHOUSE BUILDING



**9737 NEW YORK AVE
HUDSON, FL 34667**

- * Great West Pasco location in an established Industrial area.
- * Large, fenced lot with generous vehicle parking.
- * Easy access to US Highway 19 and Little Rd, the two main North/South arterials through West Pasco County.
- * Existing build-out consists of two tenant configuration, one with small office.
- * 5 OHD's approx. 14' height with approx. 16' min. clear height inside building. One OHD is dock high in truck well.

Sale Price: \$299,000

PROPERTY STATISTICS

<u>BUILDING</u>		<u>SITE</u>	
SIZE	10,716 SF	SITE SIZE	1.0 acres
YOC	1987	PARKING	Ample on site
MATERIALS	Metal	ZONING	C-2
CAM (2014)	Unknown	TAXES (2013)	\$3,247

FOR MORE INFORMATION:

Lee Koutsos
leander@figrey.com
Or

John Grey, ALC
john@figrey.com

727-849-2424



COMMERCIAL REALTOR®

Established 1924

**6328 US Hwy 19
New Port Richey
Florida 34652
www.figrey.com**

The information given herewith is obtained from sources we consider reliable. We are not responsible for misstatements of facts, errors, omissions, changes in terms or conditions, or withdrawal from the market without prior notice.

9737 NEW YORK AVE, HUDSON, FL

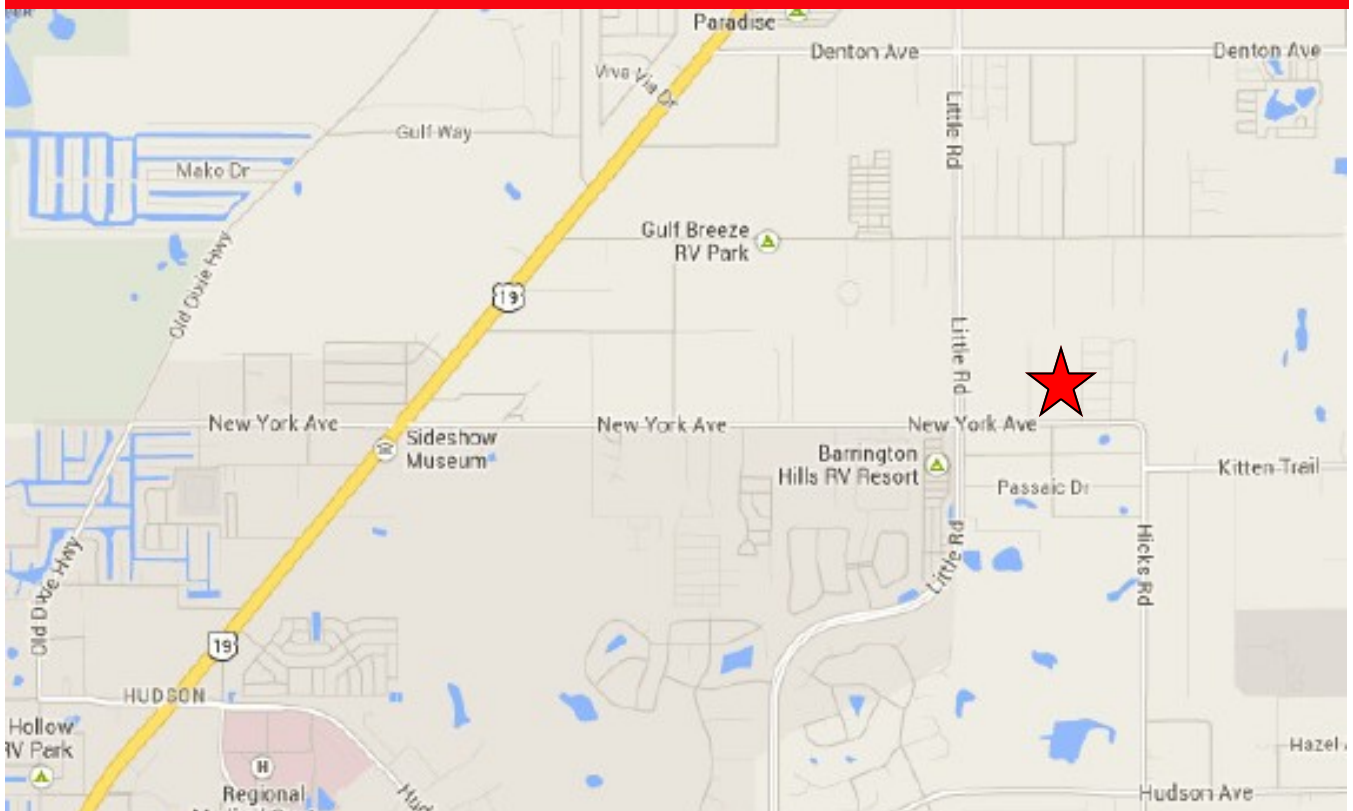

Contact: Lee Koutsos or John Grey
6328 US Hwy 19, New Port Richey, FL 34652
Phone 727-849-2424 / Fax 727-8426596 /
www.figrey.com

