

# COLLIER PARK OF COMMERCE

## PROFESSIONAL OFFICE



### FOR LEASE

3050 HORSESHOE DRIVE, NAPLES, FL 34104



### ON-SITE PROPERTY MANAGEMENT

#### CONTACT

**DAVE WALLACE, CCIM, SIOR**  
Senior Vice President  
239.659.1447 x218  
dave.wallace@creconsultants.com

**DAVID WALLACE**  
Senior Associate  
239.659.1447 x223  
david.wallace@creconsultants.com

12140 Carissa Commerce Ct, Suite 102  
Fort Myers, FL 33966  
1100 Fifth Ave. S, Suite 404  
Naples, FL 34102

#### AVAILABLE:

BUILDING	UNIT	SIZE (SF)
A	168	1,218
B	231 <i>Available 7/31/2024</i>	4,444

**LEASE RATE:** Call for Rate

**LOCATION:** Located just north of Radio Road, adjacent to the Naples Municipal Airport. This property provides tenants with a central location, excellent accessibility and good visibility, with many amenities in the immediate area.

**ZONING:** BP - Business Park District (Collier County)

**Collier Park of Commerce** is owned and managed by the Adler Group, which owns and manages an extensive real estate portfolio of properties in the Southeast United States. Adler Group professionals possess a deep understanding of the CRE industry and are extremely responsive to their tenants' needs.

The information contained herein was obtained from sources believed reliable. CRE Consultants makes no guarantees, warranties or representations as to the completeness or accuracy thereof, and is subject to errors, omissions, change of price or conditions prior to sale or lease, or withdrawal without notice. 02/14/24

# COLLIER PARK OF COMMERCE

## PROFESSIONAL OFFICE



### FOR LEASE

3050 HORSESHOE DRIVE, NAPLES, FL 34104

#### BUILDING 3050-A

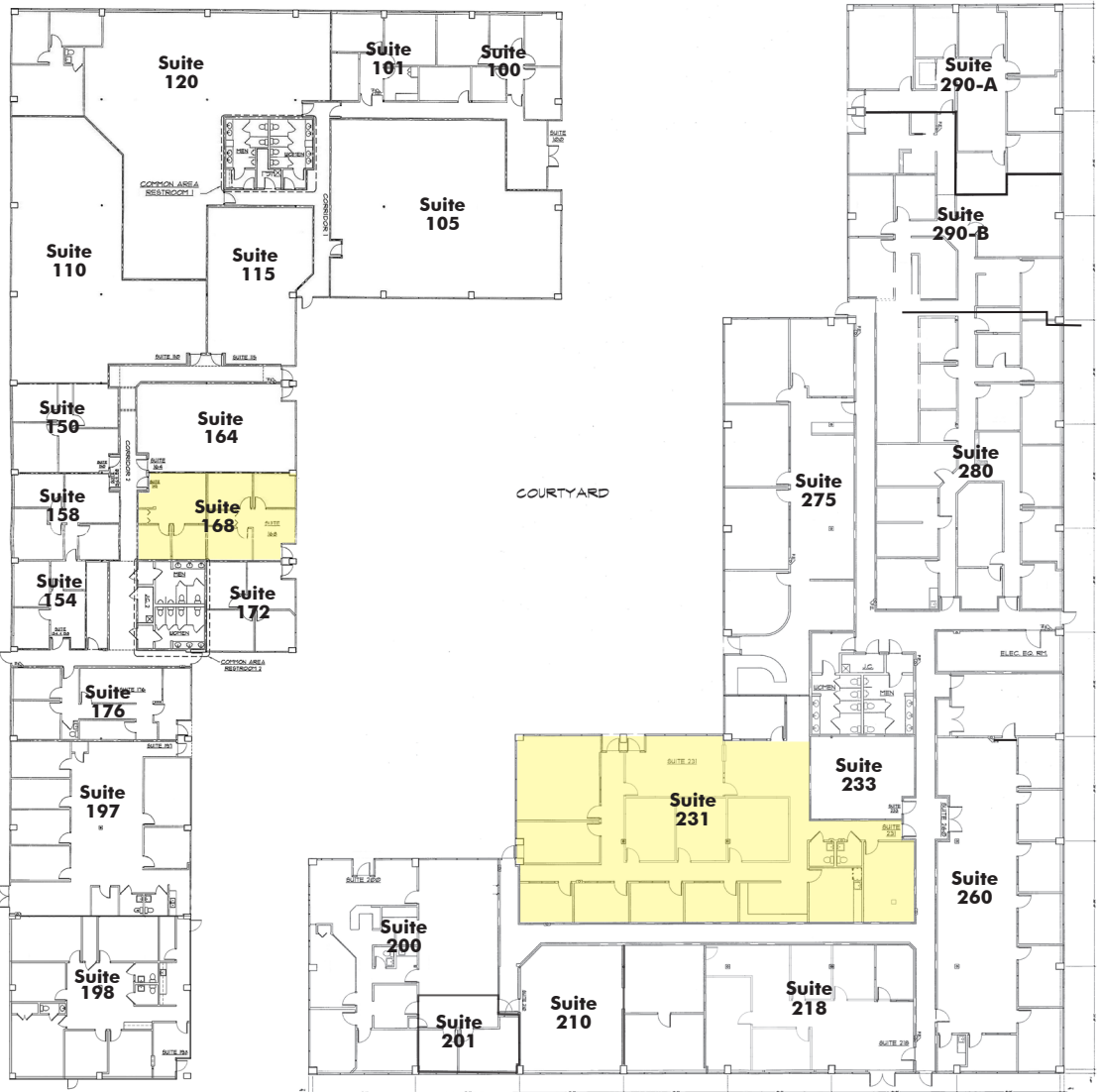

#### BUILDING 3050-B

AVAILABLE

UNIT 168



### HIGHLIGHTS

- Ample parking
- On-site property management
- Natural light and courtyard views
- Common restrooms in close proximity
- Space is move-in ready

### CONTACT

**DAVE WALLACE, CCIM, SIOR**  
 Senior Vice President  
 239.659.1447 x218  
 dave.wallace@creconsultants.com

**DAVID WALLACE**  
 Senior Associate  
 239.659.1447 x223  
 david.wallace@creconsultants.com

The information contained herein was obtained from sources believed reliable. CRE Consultants makes no guarantees, warranties or representations as to the completeness or accuracy thereof, and is subject to errors, omissions, change of price or conditions prior to sale or lease, or withdrawal without notice.

## FOR LEASE

3050 HORSESHOE DRIVE, NAPLES, FL 34104

## SYNERGISTIC COMPANIES IN IMMEDIATE TRADE AREA



Collier County  
Tax Department

Collier County  
Growth Management

Collier County  
Community Development

Collier Contractor  
Licensing

Suncoast  
Credit Union

- Salvation Army
- Southwest Florida Workforce Development
- Early Learning Coalition of SWFL
- Lutheran Services of Florida
- Blue Water Benefits Consulting

VA Clinic

Lighthouse of  
Collier

HORSESHOE DR N

3050A  
3050B

Naples Adventist  
Christian School

HORSESHOE DR S

Mason Classical  
Academy

Friends of  
Foster Children

ENTERPRISE AVE

Paws Assistant  
Dogs

Family Preservation  
Case Management DCF

Windmill Creek  
Academy

David Lawrence  
Offices

National Park  
Service

Quest for  
Success

Cobham Slip  
Rings

**CONTACT**  
**DAVE WALLACE, CCIM, SIOR**  
Senior Vice President  
239.659.1447 x218  
[dave.wallace@creconsultants.com](mailto:dave.wallace@creconsultants.com)

**DAVID WALLACE**  
Senior Associate  
239.659.1447 x223  
[david.wallace@creconsultants.com](mailto:david.wallace@creconsultants.com)

The information contained herein was obtained from sources believed reliable. CRE Consultants makes no guarantees, warranties or representations as to the completeness or accuracy thereof, and is subject to errors, omissions, change of price or conditions prior to sale or lease, or withdrawal without notice. 02/14/24